

GUTMANN RP-KSI



BUILDING SYSTEMS

ALUMINIUM EXTERIOR WINDOW SILLS & ACCESSORIES

04.2019

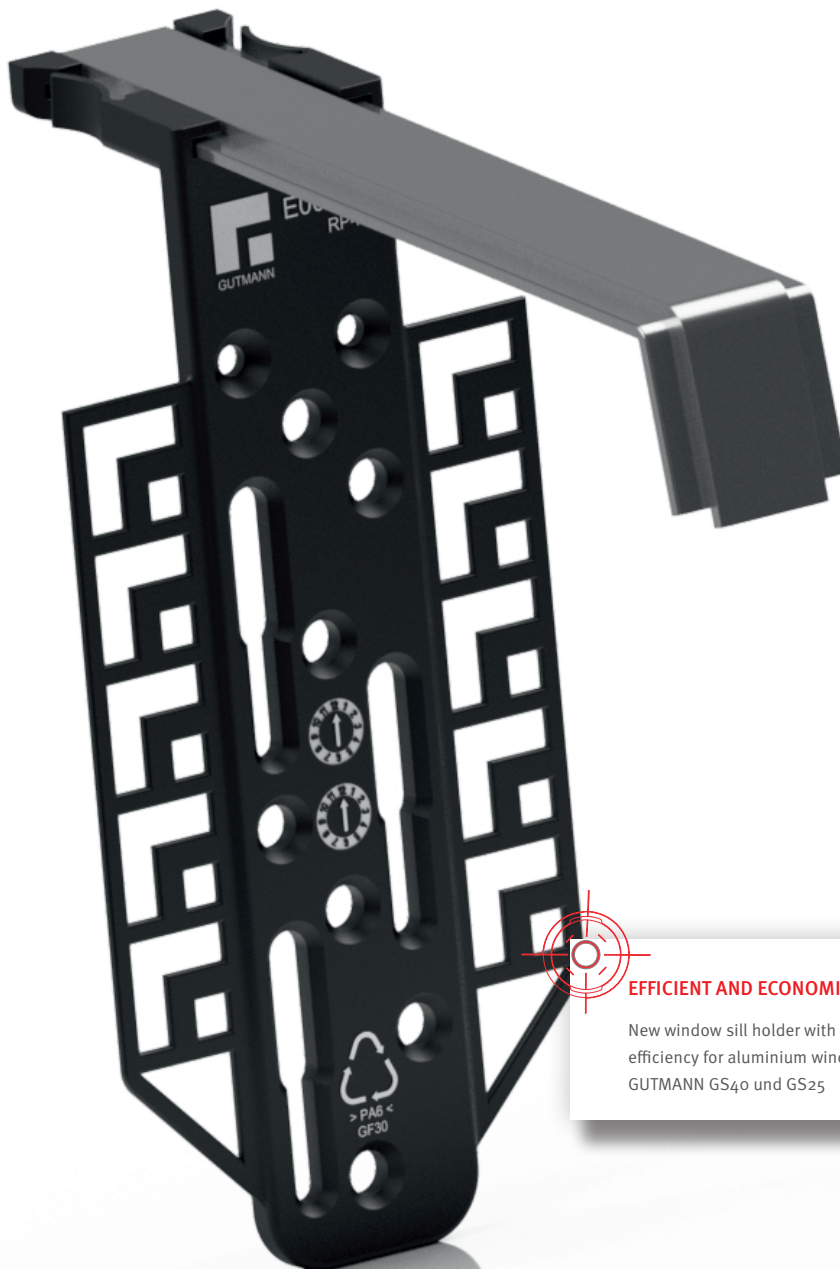

EFFICIENT AND ECONOMICAL

New window sill holder with high efficiency for aluminium window sills
GUTMANN GS40 und GS25

GUTMANN RP-KSI

WINDOW SILL HOLDER FOR GS40 AND GS25

Once again, GUTMANN is expanding its accessories range for aluminium exterior window sills. It is another expert and consistent enhancement of the overall system concept. The new, innovative GUTMANN RP-KSI window sill holder is made of high-quality polyamide plastic. This material significantly improves thermal insulation performance in the facade.

The bracket is a response to the clear trend towards high-insulating bricks without ETIC.

It is suitable for installation with a thickness of approx. 20 mm on wall constructions without ETIC.

The new accessory from GUTMANN ensures reliable stability as well as rapid fastening to the window sill thanks to an intelligent clip mechanism in the front area of the bracket. This results in additional benefits when it comes to fabrication. The GUTMANN RP-KSI window sill holder is suitable for use in GUTMANN GS40 and GS25 window sill systems.

- EFFICIENT AND ECONOMICAL - NEW WINDOW SILL HOLDER WITH HIGH EFFICIENCY

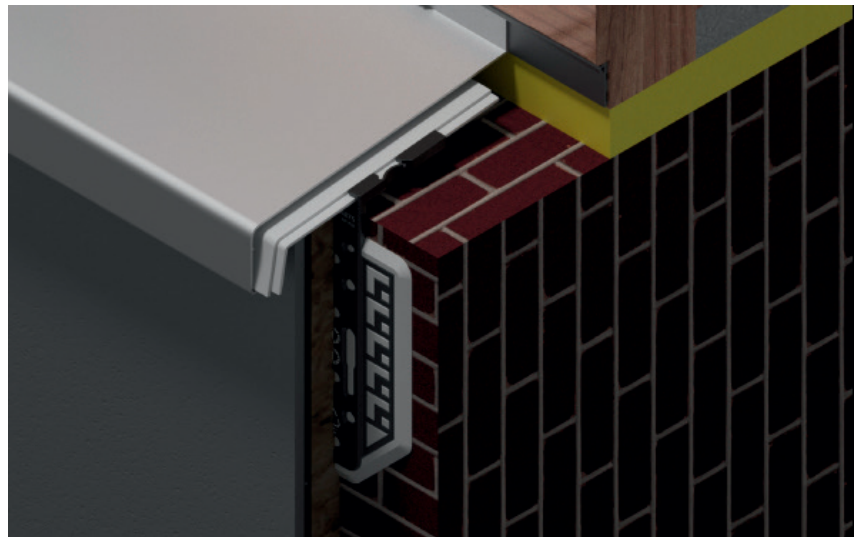
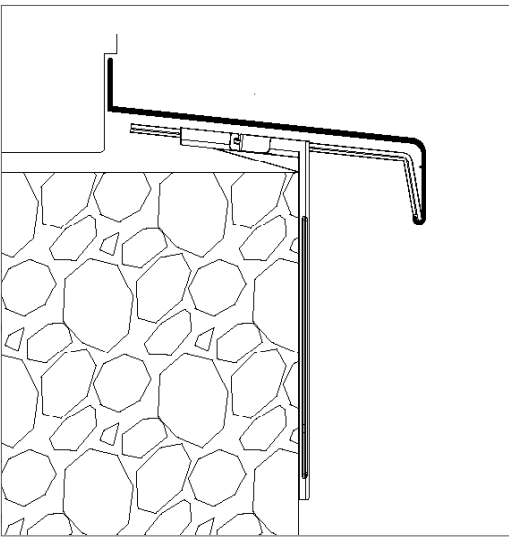

- ✓ For secure fastening of the window sill
- ✓ For use on wall constructions without ETIC
- ✓ Fast and economical installation using screws or adhesives
- ✓ Significantly improved thermal insulation values
- ✓ Infinitely adjustable using tension springs
- ✓ For use with projections of 150 mm or more in line with installation guidelines