

GUTMANN GCW 060

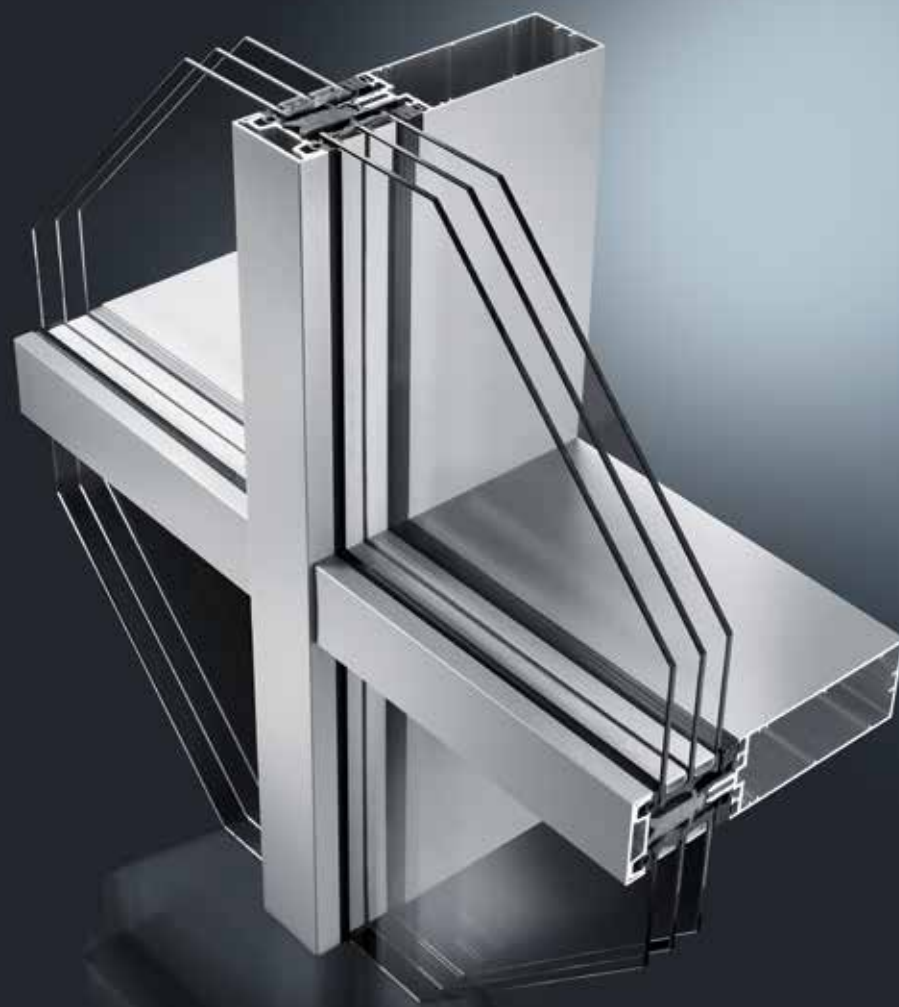

Versicherungskammer Bayern, München



ALUMINIUM
FASSADENSYS-
TEM
CURTAIN WALL SYSTEM

SYSTEMBESCHREIBUNG

Das GUTMANN Fassadensystem GCW 060 bietet Raum für eine kreative Planung sowie eine solide Konstruktion. Der einheitliche Systemaufbau unterstützt eine wirtschaftliche und rationelle Fertigung. GUTMANN GCW 060 eignet sich gut für vertikale Fassaden. Alle Gebäudearten lassen sich leicht gestalten und verkleiden.

- › Füllstärken bis 65 mm.
- › Füllgewichte bis 550 kg
- › Uf - Werte bis 0,8 W/m²K
- › Identischer Isolator für Pfosten und Riegel
- › Gleiche Profile und Dichtungen für Pfosten und Riegel, gerade Zuschnitte, kein Ausklinken der Riegelprofile: Minimierter Verschnitt, rationelle Fertigung und Montage.
- › Hohe Wirtschaftlichkeit durch identische innere und äußere Verglasungsdichtung sowie der Möglichkeit der Verglasung mit Dichtungsrahmen (vulkanisiert).
- › Ausführung in Structural Glazing (SG), Semi SG, sowie als Passivhaus-System möglich.
- › Spezieller Riegelverbinder mit Kippmoment gegen Pfosten für spaltfreien Riegelanschluss.
- › Erhöhung der statischen Werte durch Einschieben von Alu- oder Stahlprofilen realisierbar.
- › Geringe Radien für einen optisch einwandfreien Riegelanschluss bei gleichen Profilen für Pfosten und Riegel

SYSTEMEIGENSCHAFTEN / KLASSEN

	Schlagregendichtheit	RE900		Windlast	2,0 kN/m² 3,0 kN/m²
	Luftdurchlässigkeit	AE		Mechanische Festigkeit	E5/I5

WÄRMEDÄMMUNG

U_{cw} 3-fach¹

↓ 0,70

¹ Elementgröße: 4.550 x 6.000 mm | Ug Wert: 0,7 W/m²K | Up Wert: 0,25 W/m²K |
Glasabstandhalter: Thermix TX.N plus

SYSTEMSCHNITTE

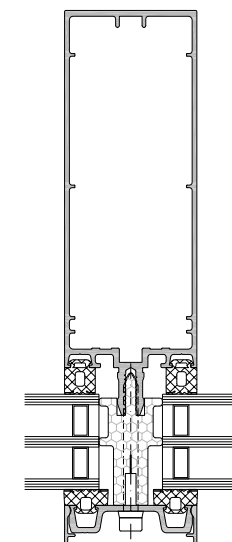
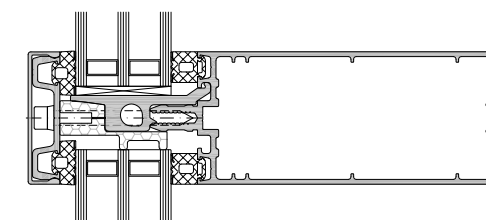

Symbolerklärung | Pictogram declaration

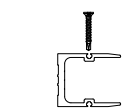

Schraube für Riegelbefestigung
Screw for transom fastening

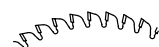

Zuschnittsmaß
Cutting dimension



Verbinderprofil
Connector profile

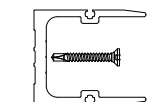

Schraube für Pfostenbefestigung
Screw for mullion fastening

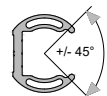

Stoßverbinder variabel
Joint connector variable

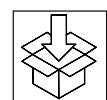

Verpackungseinheit
Packaging unit

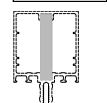

Einschiebling flach
Insert flat

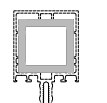

Einschiebling Rohr
Insert tube

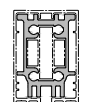

Einschubprofil
Insert profile



Einschubprofil
Insert profile

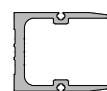

Stoßverbinder
Joint connector

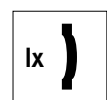

I_x Trägheitsmoment
 I_x moment of inertia

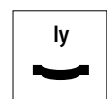

I_y Trägheitsmoment
 I_y moment of inertia

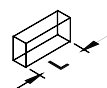

Lieferlänge
Delivery length

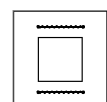

Abwicklung mechanisch
execution mechanical

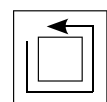

Abwicklung Eloxal
execution anodic



Nur auf Anfrage!
Upon request!



ohne AbZ!
without general technical approval!

Serie Series	Systemnummer System number	Profilname	Profile name	Seite Page
GCW 060	160055	Pfosten/Riegel 55 mm	Mullion/transom 55 mm	3
GCW 060	160075	Pfosten/Riegel 75 mm	Mullion/transom 75 mm	3
GCW 060	160095	Pfosten/Riegel 95 mm	Mullion/transom 95 mm	4
GCW 060	160115	Pfosten/Riegel 115 mm	Mullion/transom 115 mm	5
GCW 060	160135	Pfosten/Riegel 135 mm	Mullion/transom 135 mm	6
GCW 060	160155	Pfosten/Riegel 155 mm	Mullion/transom 155 mm	7
GCW 060	160175	Pfosten/Riegel 175 mm	Mullion/transom 175 mm	8
GCW 060	160195	Pfosten/Riegel 195mm	Mullion/transom 195 mm	9
GCW 060	160215	Pfosten/Riegel 215 mm	Mullion/transom 215 mm	10
GCW 060	161095	Montagepfosten 95 mm	Assembly mullion 95 mm	11
GCW 060	161115	Montagepfosten 115 mm	Assembly mullion 115 mm	11
GCW 060	161135	Montagepfosten 135 mm	Assembly mullion 135 mm	12
GCW 060	161155	Montagepfosten 155 mm	Assembly mullion 155 mm	13
GCW 060	162095	Eckpfosten 95 mm	Corner mullion 95 mm	14
GCW 060	169012	Deckleiste	Cover plate	15
GCW 060	169016	Deckleiste	Cover plate	15
GCW 060	169020	Deckleiste	Cover plate	15
GCW 060	169030	Deckleiste	Cover plate	15
GCW 060	169210	Druckleiste	Pressure plate	16
GCW 060	169230	Druckleiste	Pressure plate	16
GCW 060	169300	Druckleiste	Pressure plate	16
GCW 060	169300 L	Druckleiste	Pressure plate	16
GCW 060	169301	Druckleiste	Pressure plate	16
GCW 060	169302	Druckleiste RC2	Pressure plate RC2	16
GCW 060	169313	Druckleiste	Pressure plate	16
GCW 060	446001	Stoßverbinder GCW 060	Joint connector GCW 060	25
GCW 060	446005	Variabler Stoßverbinder	Variable joint connector	25
GCW 060	446005 2	Variabler Stoßverbinder	Variable joint connector	25
GCW 060	460065	Klemmplatte	Clamping plate	25
GCW 060	465022	Einschubprofil GCW 060	Insert profile GCW 060	24
GCW 060	465025	Einschubprofil GCW 060	Insert profile GCW 060	17
GCW 060	465026	Einschubprofil GCW 060	Insert profile GCW 060	18
GCW 060	465027	Einschubprofil GCW 060	Insert profile GCW 060	19
GCW 060	465028	Einschubprofil GCW 060	Insert profile GCW 060	20
GCW 060	465029	Einschubprofil GCW 060	Insert profile GCW 060	21
GCW 060	465030	Einschubprofil GCW 060	Insert profile GCW 060	22
GCW 060	465031	Einschubprofil GCW 060	Insert profile GCW 060	23

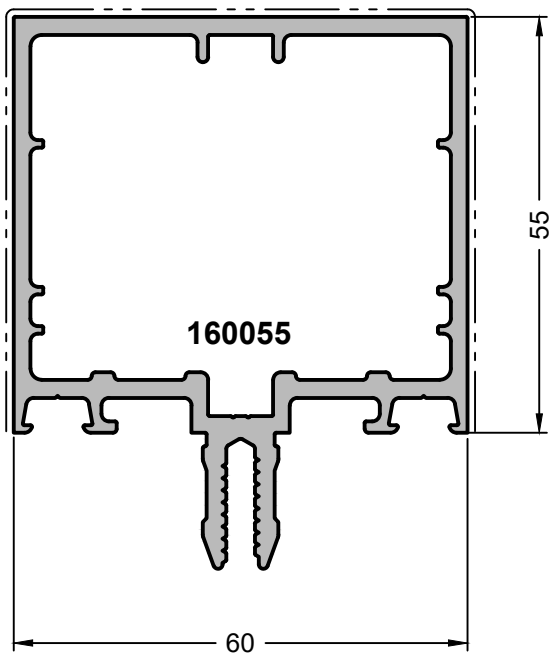

160055

Pfosten/Riegel 55 mm | Mullion/transom 55 mm

	1		6000 mm
	351 mm		170 mm
I_x	35,99 cm ⁴	I_y	28,69 cm ⁴

Verbinder | Connectors

	760602	446001	39 mm	834810	864219
		446005	39 mm	834810	864219 / 834213
		465022	40 mm	864219	

Aussteifung | Stiffening

	40x50x3		50x8
--	---------	--	------

Bei Einsatz der Einschieblinge (Rohr oder Flach) Statikliste K-00811 beachten! When using the inserts (pipe or flat), observe the static list K-00811!

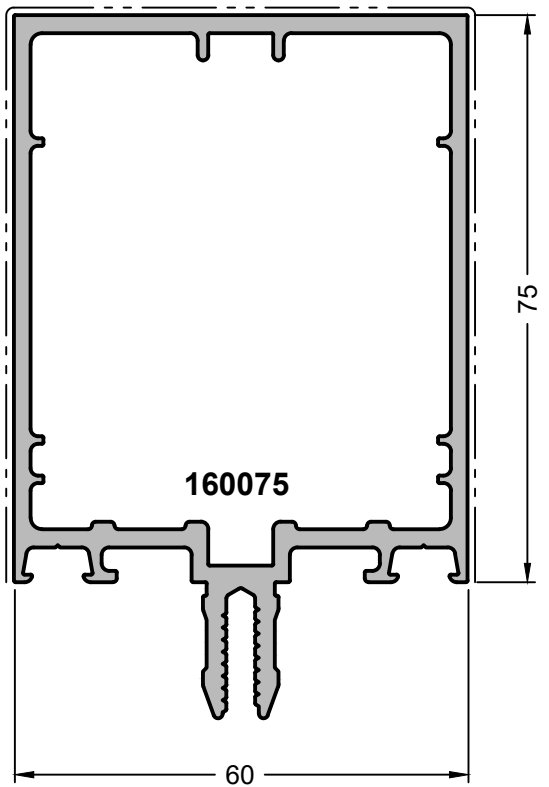

160075

Pfosten/Riegel 75 mm | Mullion/transom 75 mm

	1		6000 mm
	391 mm		210 mm
I_x	71,40 cm ⁴	I_y	36,28 cm ⁴

Verbinder | Connectors

	760603	446001	59 mm	834810	864219
		446005	59 mm	834810	864219 / 834213
		465022	60 mm	834810	

Aussteifung | Stiffening



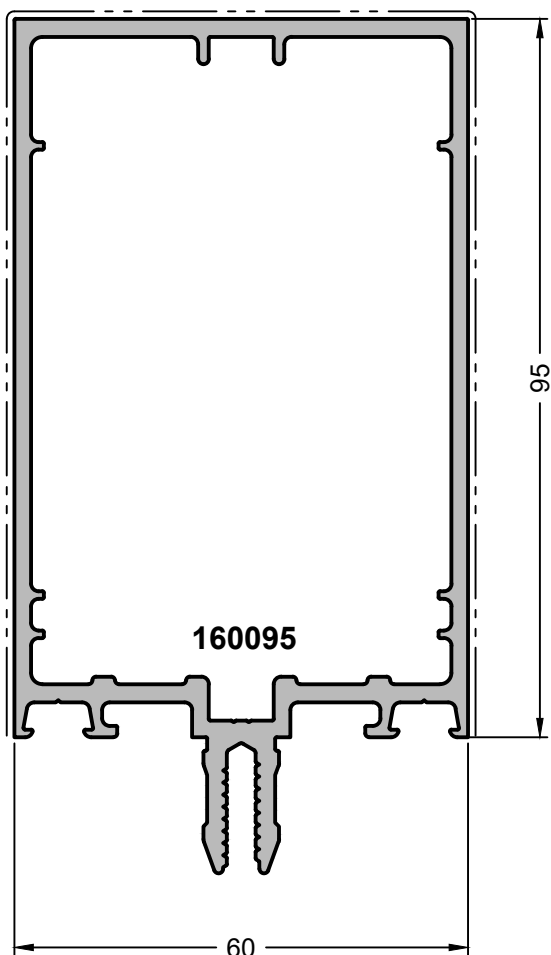

	60x50x3		70x8
--	---------	--	------

Bei Einsatz der Einschieblinge (Rohr oder Flach) Statikliste K-00811 beachten! Nur auf Anfrage! When using the inserts (pipe or flat), observe the static list K-00811! Upon request!





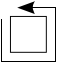
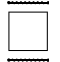

160095

Pfosten/Riegel 95 mm | Mullion/transom 95 mm

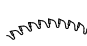
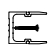
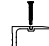
	1		6000 mm
	431 mm		250 mm
I_x 	121,83 cm ⁴	I_y 	43,67 cm ⁴

Verbinder | Connectors

					
	760604	446001	79 mm	834810	864219
		446005	79 mm	834810	864219 / 834213
		465022	80 mm	864219	

Aussteifung | Stiffening

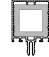
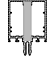
	465025		80x50x3		90x8
---	--------	---	---------	---	------

Bei Einsatz der Einschleiblinge (Rohr oder Flach)
Statikliste K-00811 beachten!

When using the inserts (pipe or flat), observe the
static list K-00811!

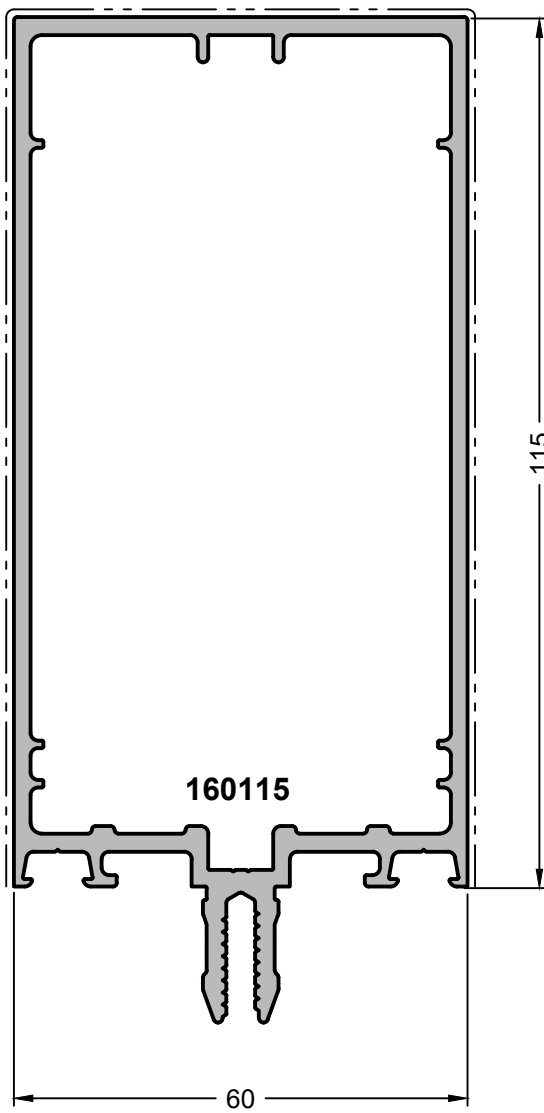

160115

Pfosten/Riegel 115 mm | Mullion/transom 115 mm

	1		6000 mm
	471 mm		290 mm
I_x	189,25 cm ⁴	I_y	51,01 cm ⁴

Verbinder | Connectors

	760605	446001	99 mm	834810
		446005	99 mm	834810
		465022	100 mm	864219
				864219 / 834213

Aussteifung | Stiffening

	465026		100x50x4		110x8
--	--------	--	----------	--	-------



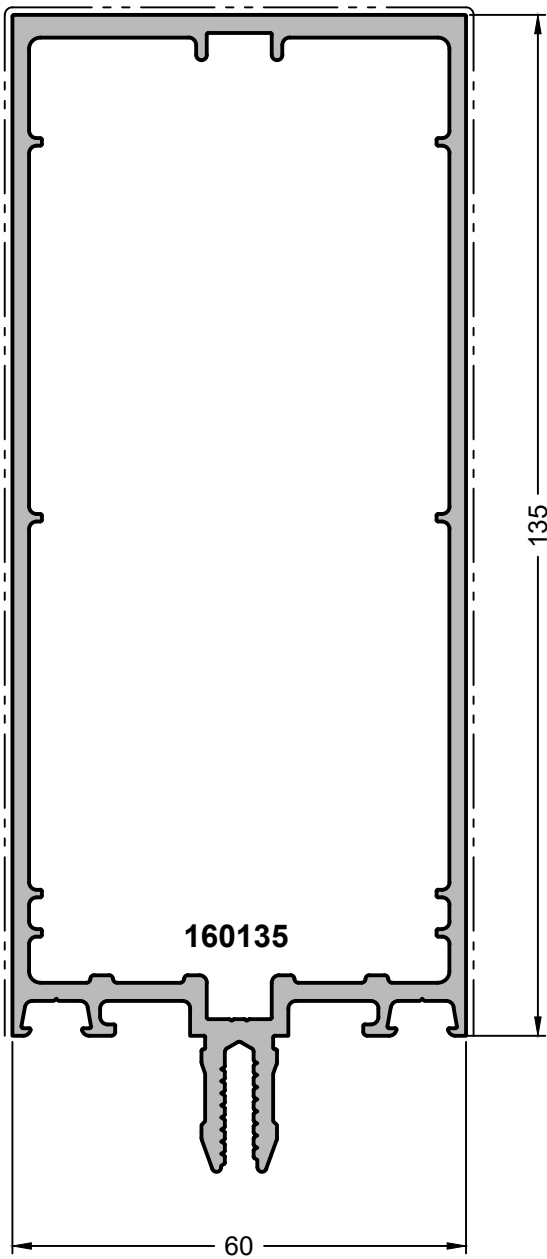

Bei Einsatz der Einschieblinge (Rohr oder Flach)
Statikliste K-00811 beachten!

When using the inserts (pipe or flat), observe the
static list K-00811!





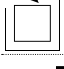
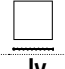

160135

Pfosten/Riegel 135 mm | Mullion/transom 135 mm

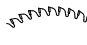
	1		6000 mm
	511 mm		330 mm
I_x 	289,63 cm ⁴	I_y 	59,54 cm ⁴

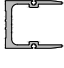
Verbinder | Connectors

					
	760606	446001	119 mm	834810	864219
		446005	119 mm	834810	864219 / 834213
		465022	120 mm	864219	

Aussteifung | Stiffening

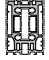
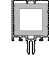
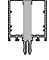
	465027		120x50x4		130x8
---	--------	---	----------	---	-------

Bei Einsatz der Einschieblinge (Rohr oder Flach)
Statikliste K-00811 beachten!

When using the inserts (pipe or flat), observe the
static list K-00811!

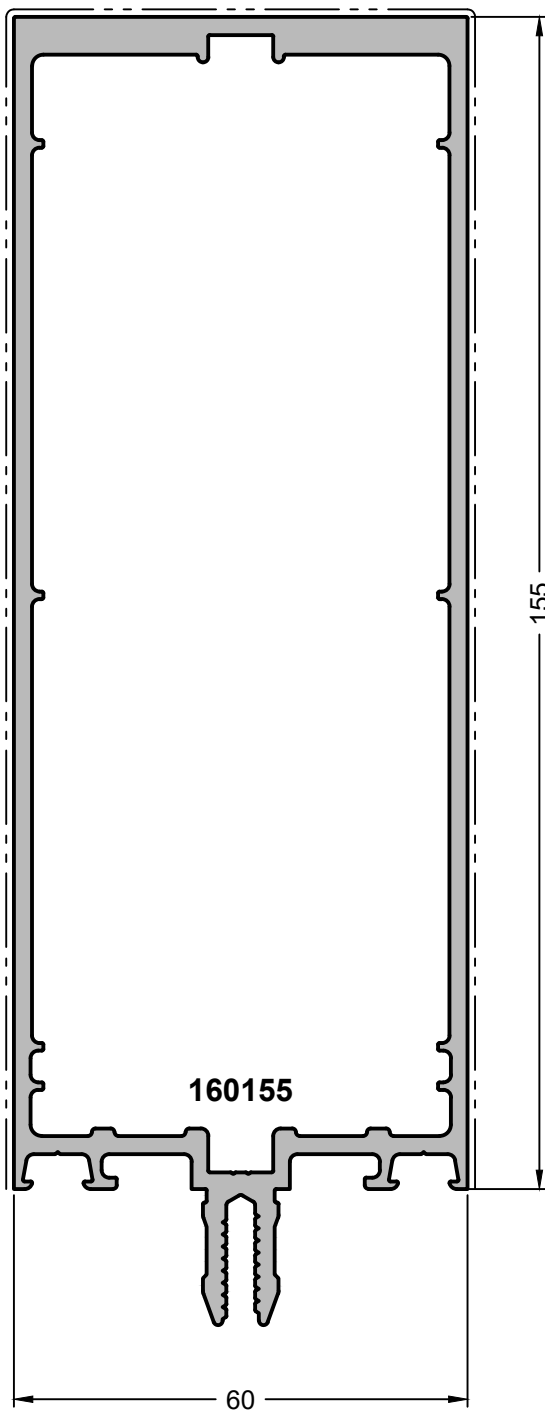

160155

Pfosten/Riegel 155 mm | Mullion/transom 155 mm

	1		6000 mm
	551 mm		370 mm
I_x	462,20 cm ⁴	I_y	73,67 cm ⁴

Verbinder | Connectors

	760607	446001	139 mm	834810
		446005	139 mm	834810
		465022	140 mm	864219
				864219 / 834213

Aussteifung | Stiffening

	465028		140x50x4		150x8
--	--------	--	----------	--	-------

Bei Einsatz der Einschieblinge (Rohr oder Flach) Statikliste K-00811 beachten!

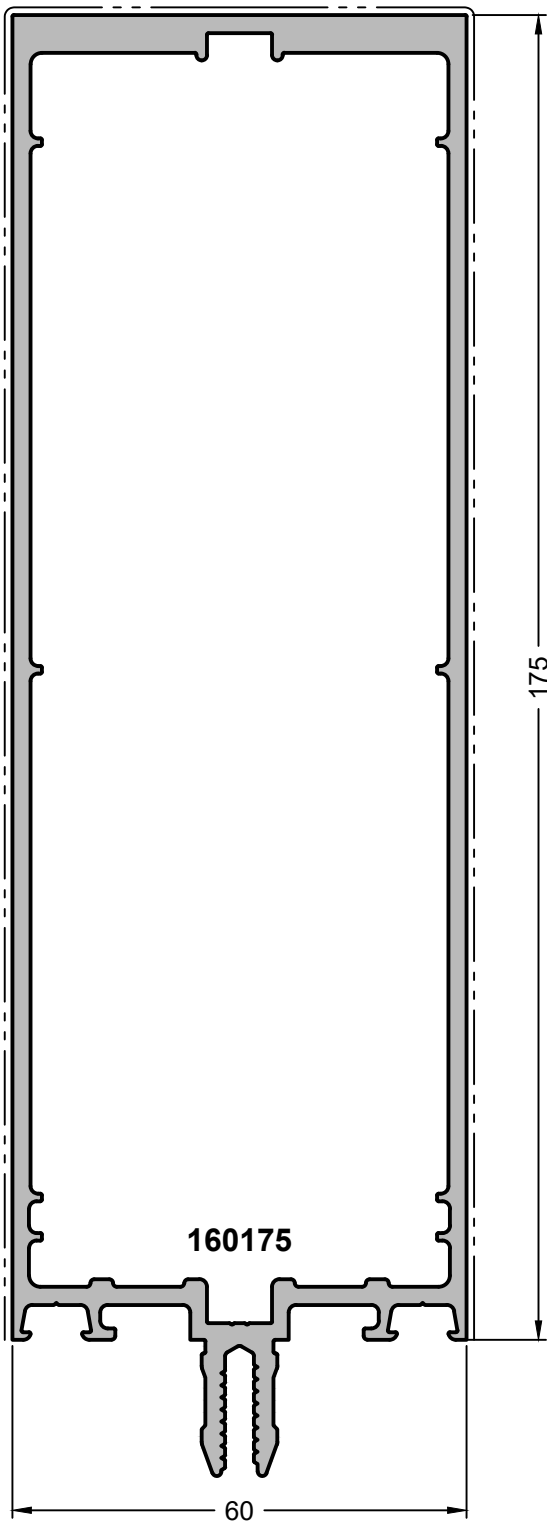

When using the inserts (pipe or flat), observe the static list K-00811!

1
2





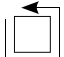
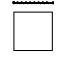

160175

Pfosten/Riegel 175mm | Mullion/transom 175 mm

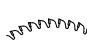
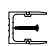
	1		6000 mm
	592 mm		410 mm
Ix)	-	Iy)	-

Verbinder | Connectors

				
	760608	446001	159 mm	834810
		446005	159 mm	834810
		465022	160 mm	864219
				864219 / 834213

Aussteifung | Stiffening

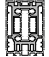
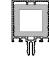
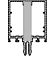
	465029		160x50x4		170x8
---	--------	---	----------	---	-------

Bei Einsatz der Einschleiblinge (Rohr oder Flach)
Statikliste K-00811 beachten!
Nur auf Anfrage!

When using the inserts (pipe or flat), observe the
static list K-00811!
Upon request!

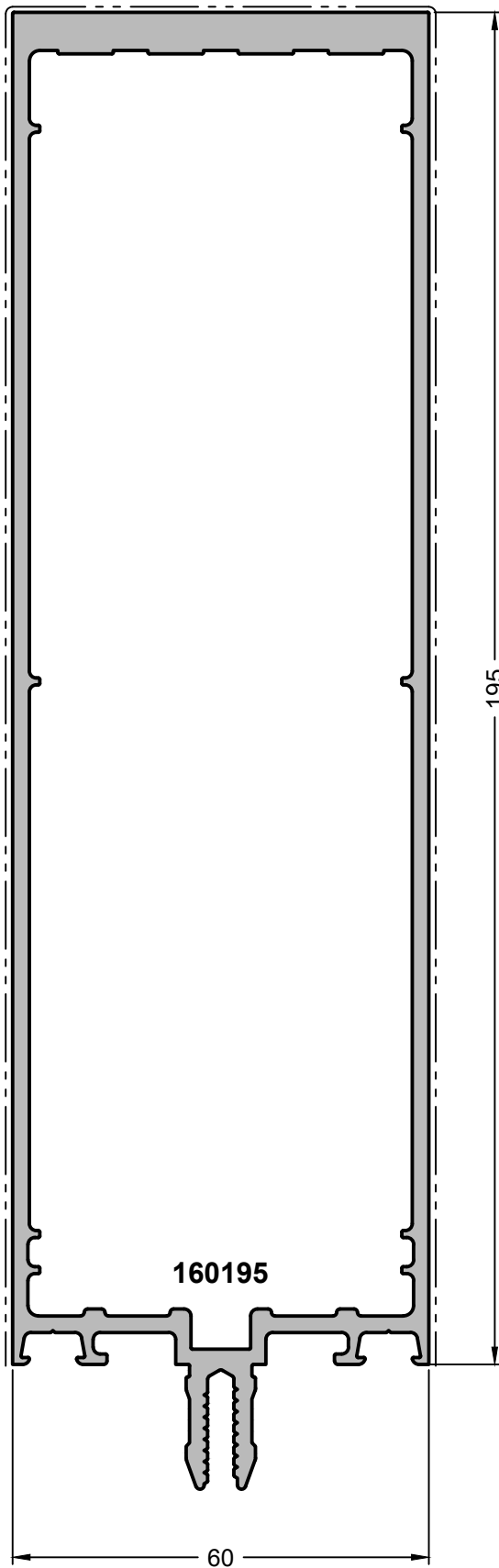

160195

Pfosten/Riegel 195mm | Mullion/transom 195 mm

	1		6000 mm
	631 mm		450 mm
I_x	849,65 cm ⁴	I_y	90,66 cm ⁴

Verbinder | Connectors

	760609	446001	179 mm	834810
		446005	179 mm	834810
		465022	180 mm	864219
				864219 / 834213

Aussteifung | Stiffening

	465030		180x50x4	
--	--------	--	----------	--





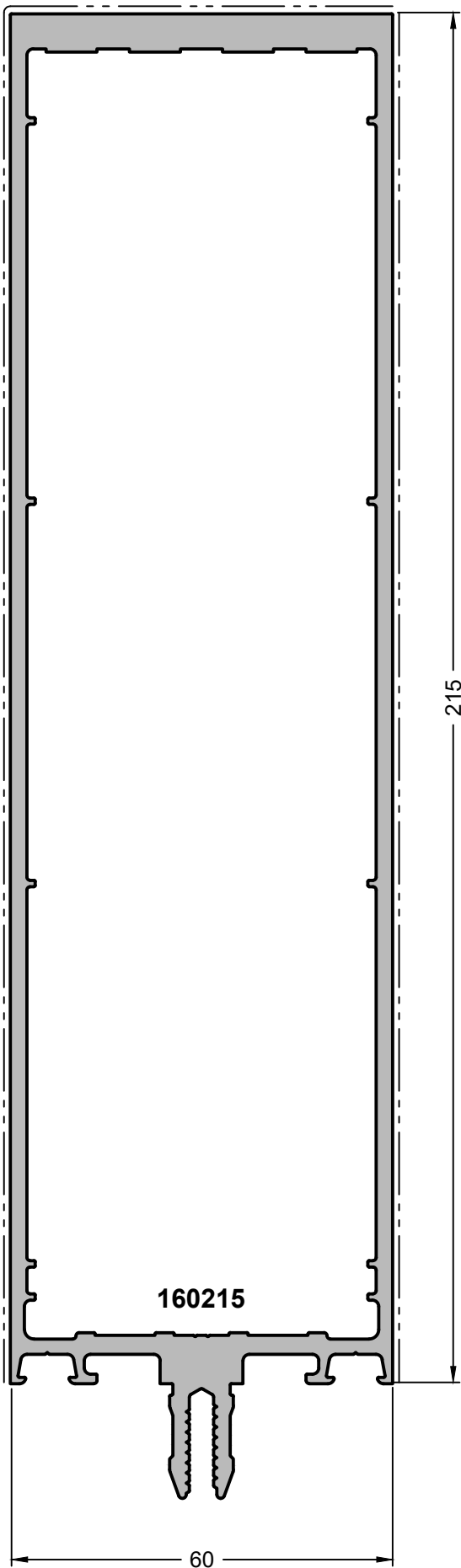

Bei Einsatz der Einschieblinge (Rohr oder Flach) Statikliste K-00811 beachten!

When using the inserts (pipe or flat), observe the static list K-00811!



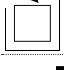



160215

Pfosten/Riegel 215 mm | Mullion/transom 215 mm

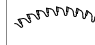
	1		6000 mm
	671 mm		490 mm
I_x 	1157,00 cm ⁴	I_y 	104,80 cm ⁴

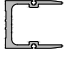
Verbinder | Connectors

					
	760622	446001	199 mm	834810	864219
		446005	199 mm	834810	864219 / 834213
		465022	200 mm	864219	

Aussteifung | Stiffening

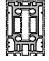
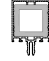
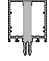
	465031		200x50x4		-
---	--------	---	----------	---	---

Bei Einsatz der Einschieblinge (Rohr oder Flach)
Statikliste K-00811 beachten!

When using the inserts (pipe or flat), observe the
static list K-00811!

161095

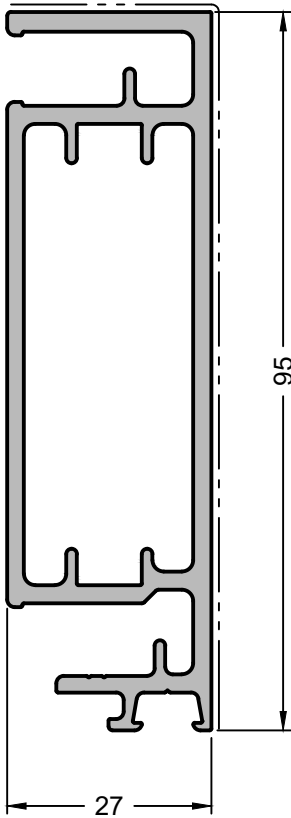

161095

Montagepfosten 95 mm | Assembly mullion 95 mm

	1		6000 mm
	358 mm		122 mm
Ix	60,26 cm ⁴	Iy	6,54 cm ⁴

Aussteifung | Stiffening

	50x20x3		60x8
--	---------	--	------

Bei Einsatz der Einschieblinge (Rohr oder Flach) Statikliste K-00811 beachten!

When using the inserts (pipe or flat), observe the static list K-00811!

161115

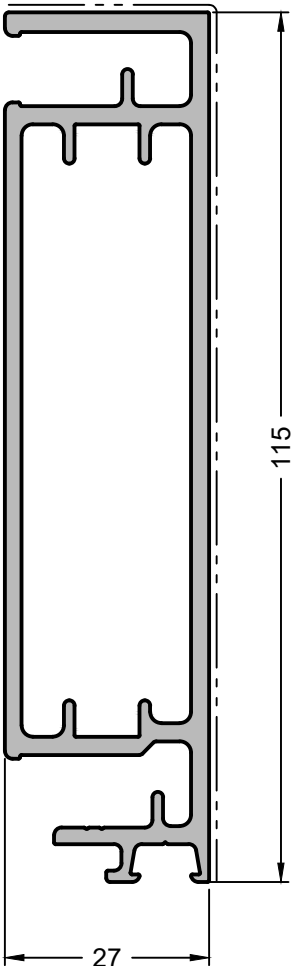

161115

Montagepfosten 115 mm | Assembly mullion 115 mm

	1		6000 mm
	398 mm		142 mm
Ix	102,42 cm ⁴	Iy	7,96 cm ⁴

Aussteifung | Stiffening

	70x20x3		80x8
--	---------	--	------

Bei Einsatz der Einschieblinge (Rohr oder Flach) Statikliste K-00811 beachten!





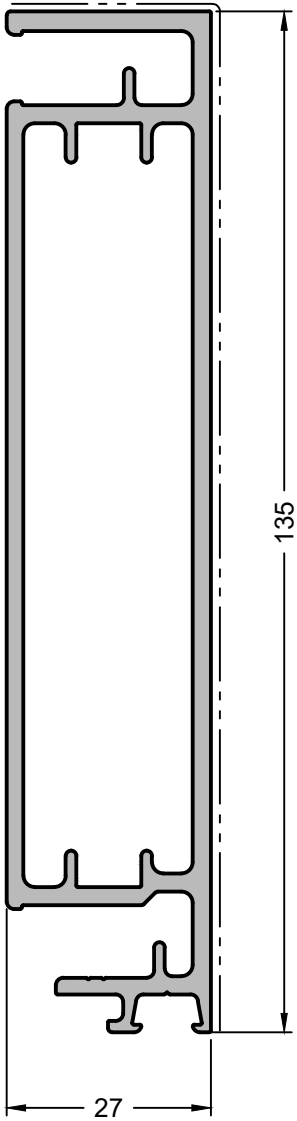

When using the inserts (pipe or flat), observe the static list K-00811!

161135

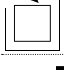

161135

Montagepfosten 135 mm | Assembly mullion 135 mm

	1		6000 mm
	438 mm		162 mm
I_x 	159,28 cm ⁴	I_y 	9,34 cm ⁴

Aussteifung | Stiffening

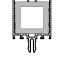
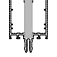
	90x20x3		100x8
---	---------	---	-------

Bei Einsatz der Einschieblinge (Rohr oder Flach)
Statikliste K-00811 beachten!

When using the inserts (pipe or flat), observe the
static list K-00811!

161155

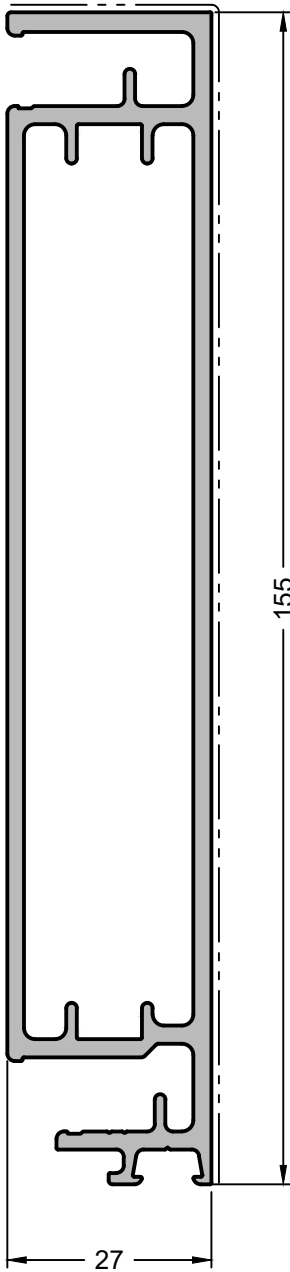

161155

Montagepfosten 155 mm | Assembly mullion 155 mm

	1		6000 mm
	478 mm		182 mm
Ix	233,36 cm ⁴	Iy	10,77 cm ⁴

Aussteifung | Stiffening

	110x20x3		120x8
--	----------	--	-------

Bei Einsatz der Einschieblinge (Rohr oder Flach)
Statikliste K-00811 beachten!

When using the inserts (pipe or flat), observe the
static list K-00811!

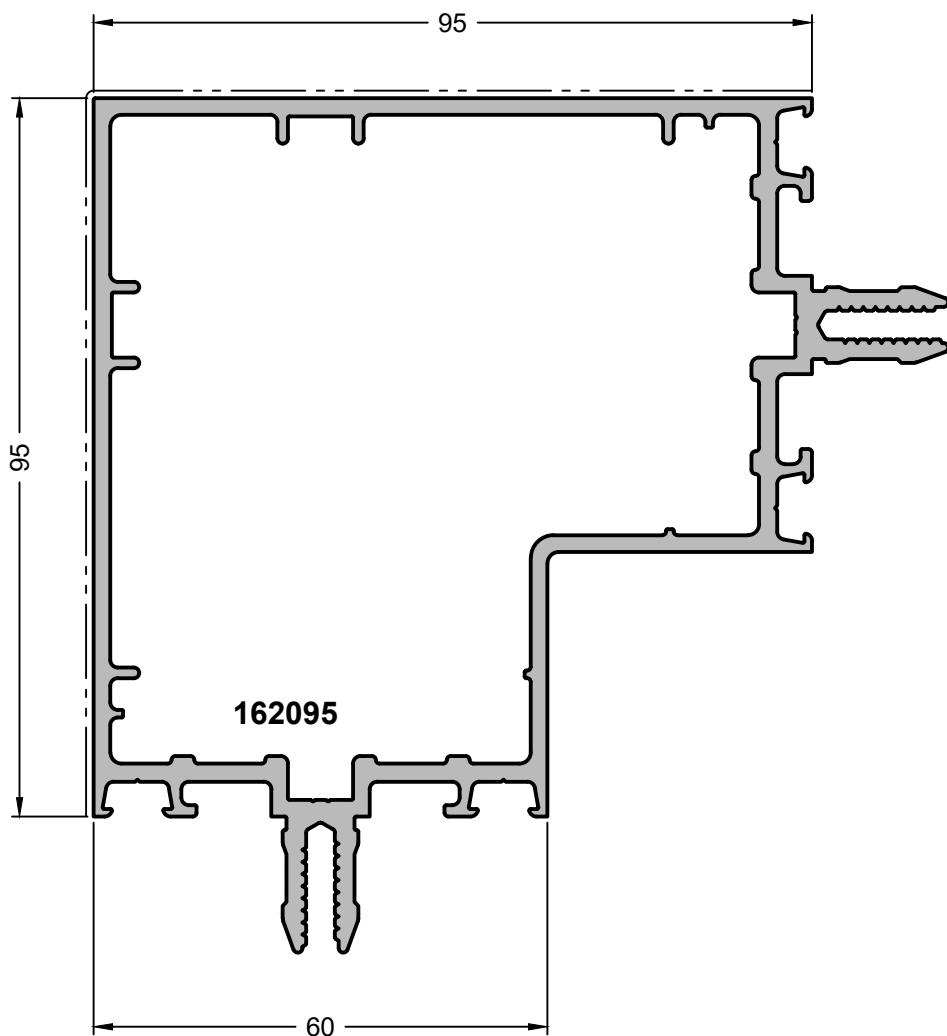

162095

Eckpfosten 95 mm | Corner mullion 95 mm

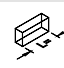
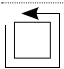
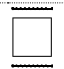
	1		6000 mm
	622 mm		260 mm
I_x)	149,70 cm ⁴	I_y)	149,70 cm ⁴

Aussteifung | Stiffening

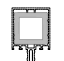
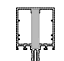
	80x50x4		90x8
---	---------	---	------

Bei Einsatz der Einschleiflinge (Rohr oder Flach)
Statikliste K-00811 beachten!

When using the inserts (pipe or flat), observe the
static list K-00811!

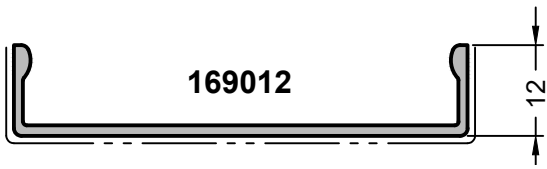

169012

Deckleiste | Cover plate

	1		6000 mm
	165 mm		84 mm

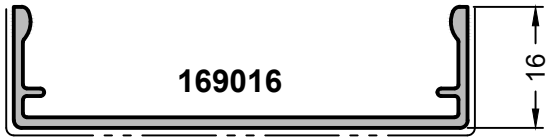

169016

Deckleiste | Cover plate

	1		6000 mm
	191 mm		92 mm

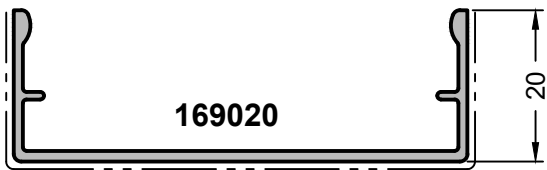

169020

Deckleiste | Cover plate

	1		6000 mm
	207 mm		100 mm

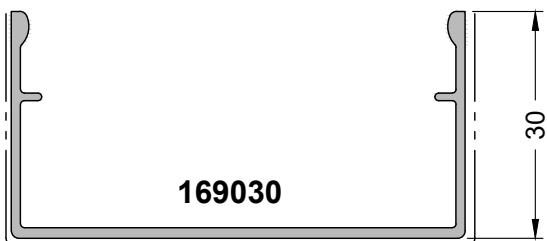

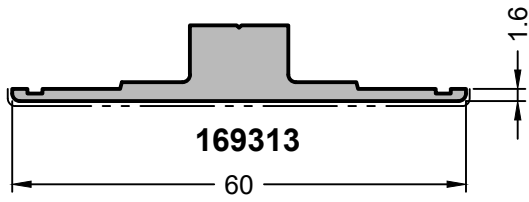

169030

	1		6000 mm
	247 mm		120 mm



169313



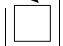
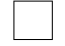

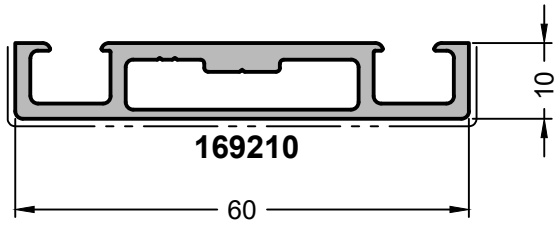
Druckleiste | Pressure plate

	1		6000 mm
	140 mm		60 mm



169210

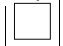

Druckleiste | Pressure plate

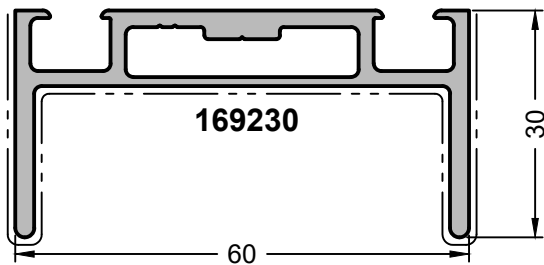
	1		6000 mm
	181 mm		80 mm



169230

Druckleiste | Pressure plate

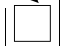
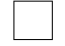
	1		6000 mm
	259 mm		158 mm

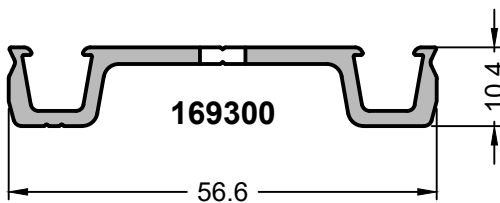

169300

Druckleiste | Pressure plate

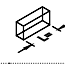
	1		6000 mm
Gelocht Ø 6 mm.		Punched Ø 6 mm.	

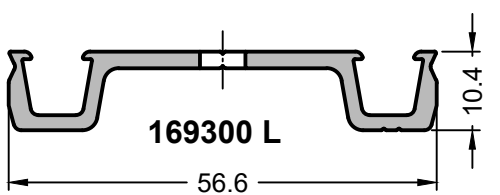

169300 L

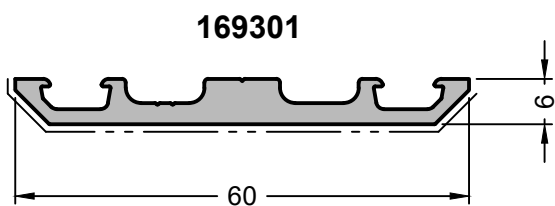

Druckleiste | Pressure plate

	1		6000 mm
Gelocht, Langloch 7 x 20 mm. Nur auf Anfrage!		Punched, oblong hole 7 x 20 mm. Upon request!	



169301

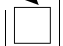
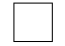

Druckleiste | Pressure plate

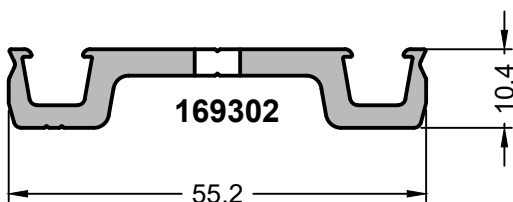
	1		6000 mm
	155 mm		67 mm



169302

Druckleiste RC2 | Pressure plate RC2

	1		6000 mm
Gelocht Ø 6 mm.		Punched Ø 6 mm	

465025



465025

Einschubprofil | Insert profile

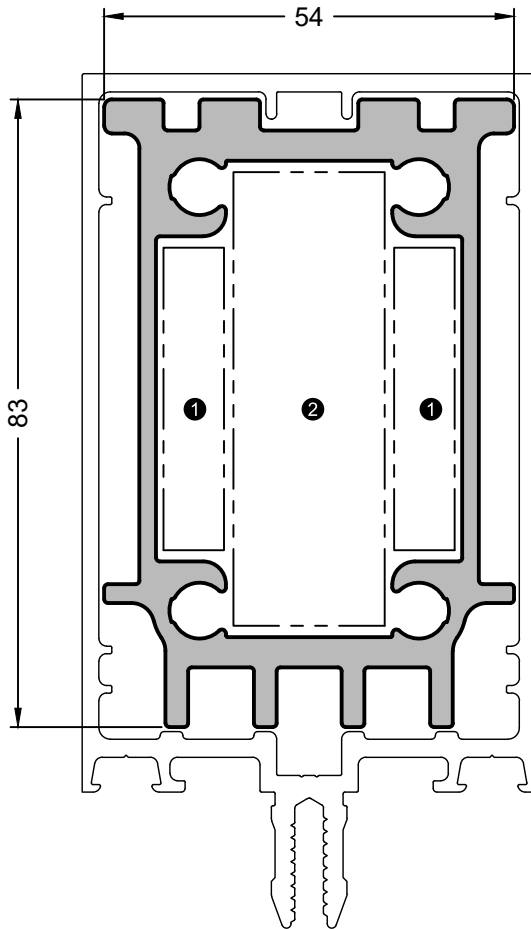

1



6000 mm

ix

91,78 cm⁴

ly

29,72 cm⁴

Passend zu 160095

Suitable for 160095



1

8 x 40 mm

2

20 x 60 mm

465026



465026

Einschubprofil | Insert profile



1



6000 mm

I_x

160,24 cm⁴

I_y

33,73 cm⁴

Passend zu 160115

Suitable for 160115



①

8 x 60 mm

②

20 x 80 mm

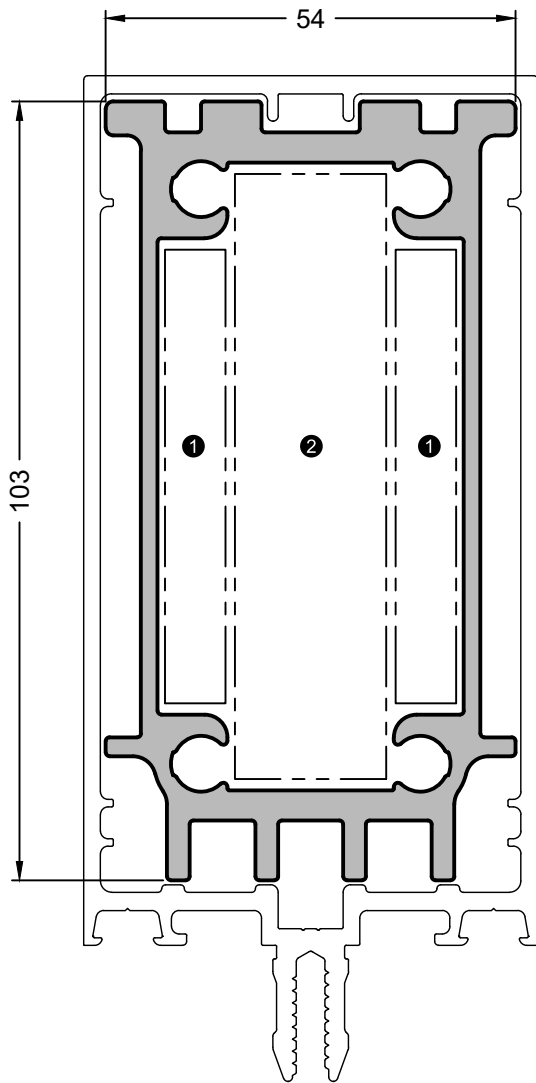

465027

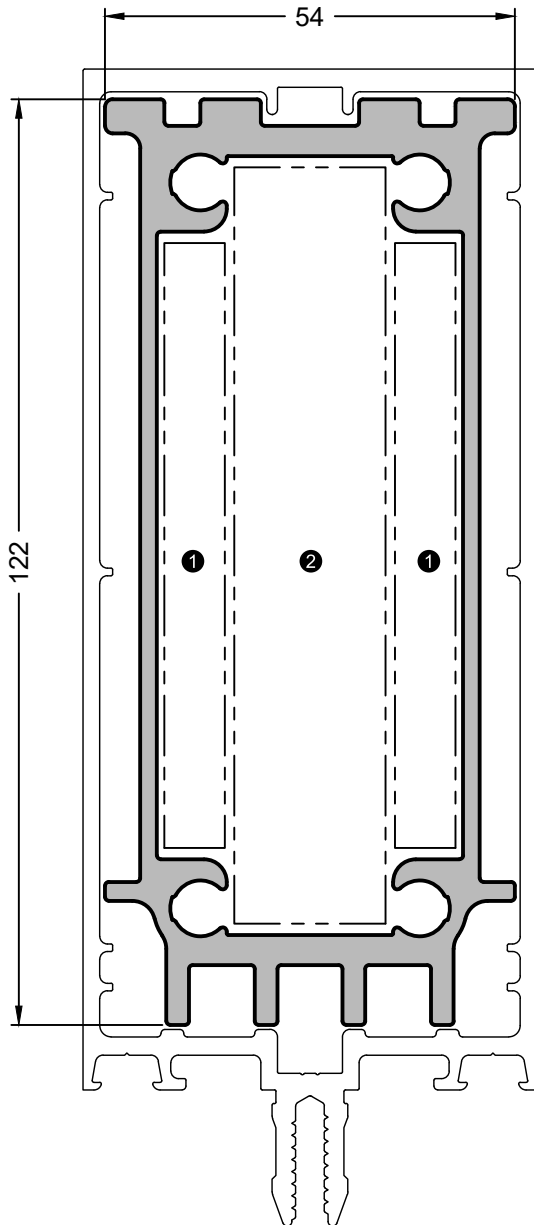

465027

Einschubprofil | Insert profile



1



6000 mm



246,46 cm⁴

ly

37,47 cm⁴

Passend zu 160135

Suitable for 160135



①

8 x 80 mm

②

20 x 100 mm

465028



465028

Einschubprofil | Insert profile



1



6000 mm

I_x

335,96 cm⁴

I_y

41,69 cm⁴

Passend zu 160155

Suitable for 160155



①

8 x 100 mm

②

20 x 120 mm

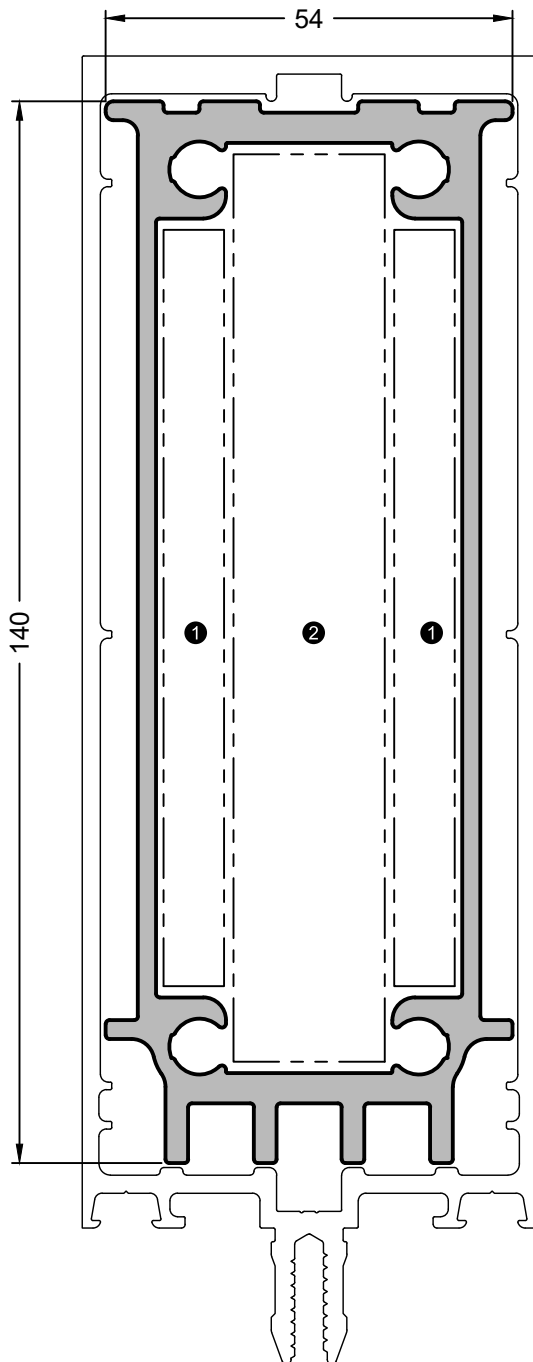

465029



465029

Einschubprofil | Insert profile



1



6000 mm

lx

468,84 cm⁴

ly

46,12 cm⁴

Passend zu 160175

Suitable for 160175



①

8 x 120 mm

②

20 x 140 mm

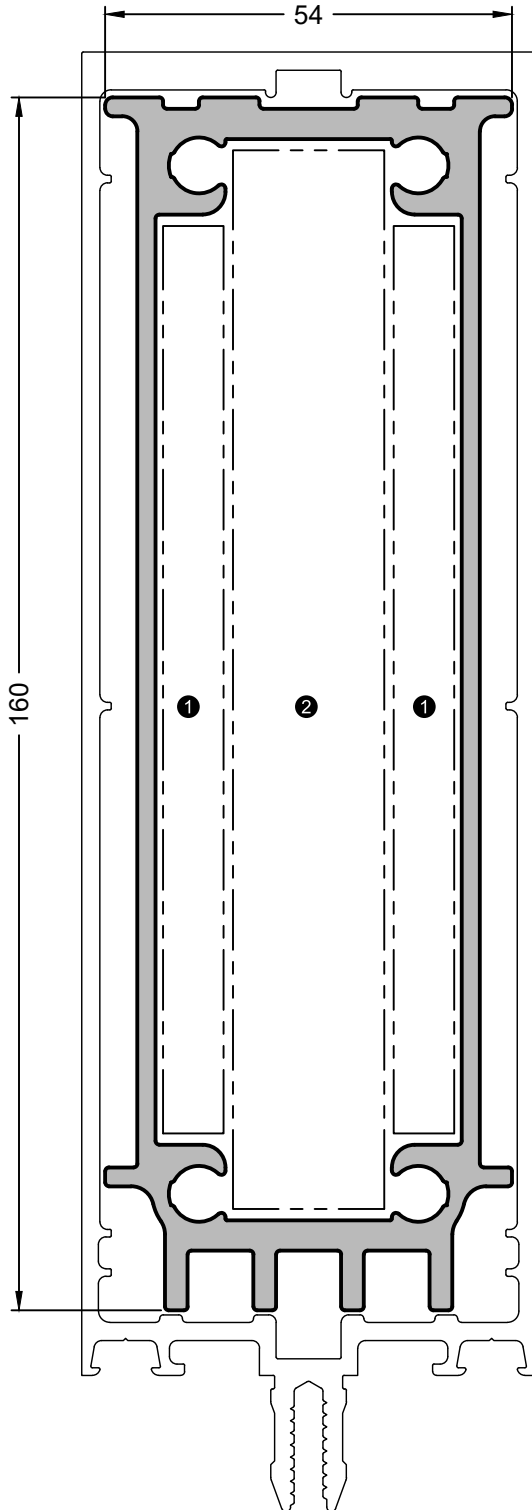

465030



465030

Einschubprofil | Insert profile



1



6000 mm

I_x

616,35 cm⁴

I_y

49,94 cm⁴

Passend zu 160195

Suitable for 160195



①

8 x 140 mm

②

20 x 160 mm

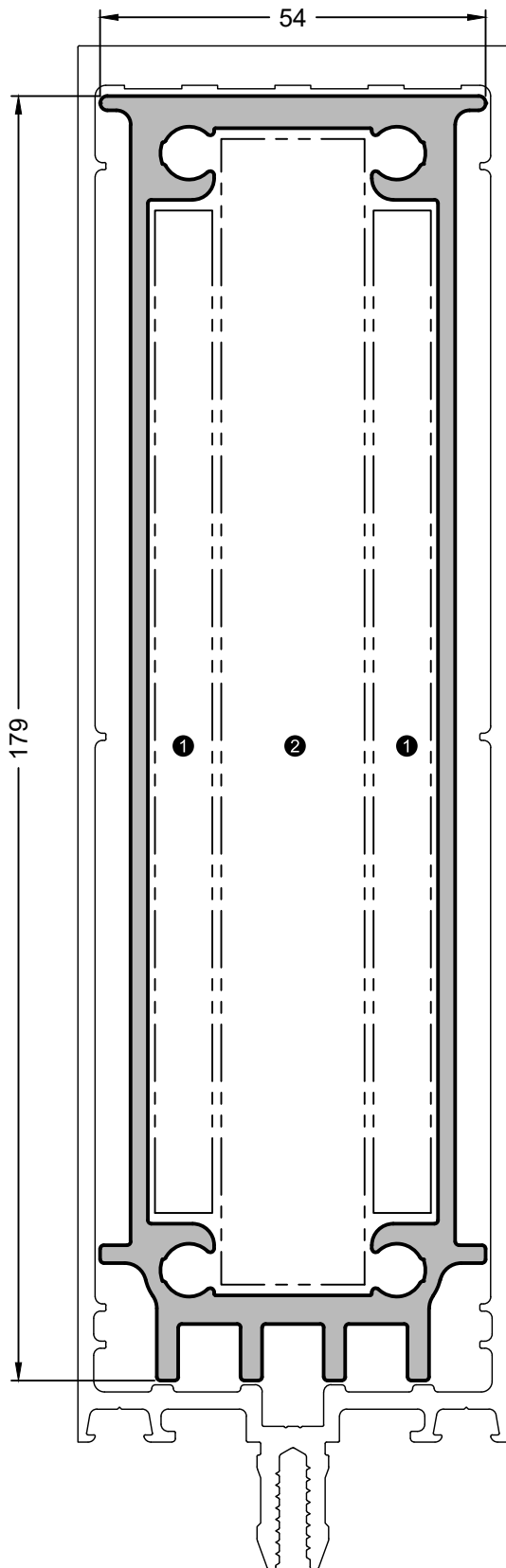

465031



465031

Einschubprofil | Insert profile



1



6000 mm



800,80 cm⁴



54,21 cm⁴

Passend zu 160215

Suitable for 160215



①

8 x 160 mm

②

20 x 180 mm

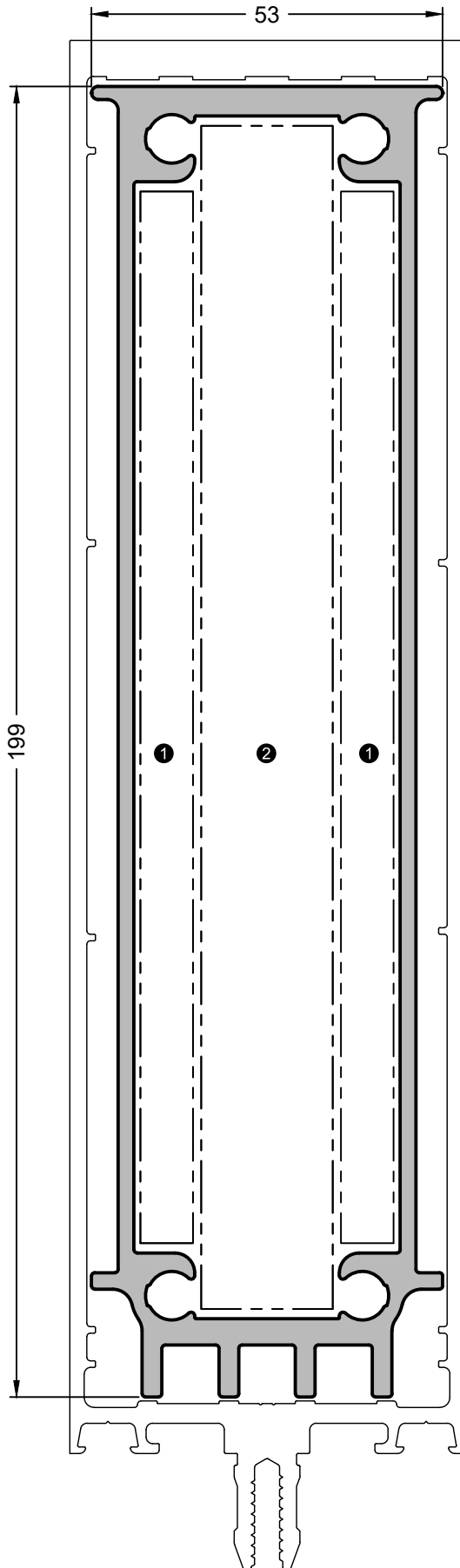

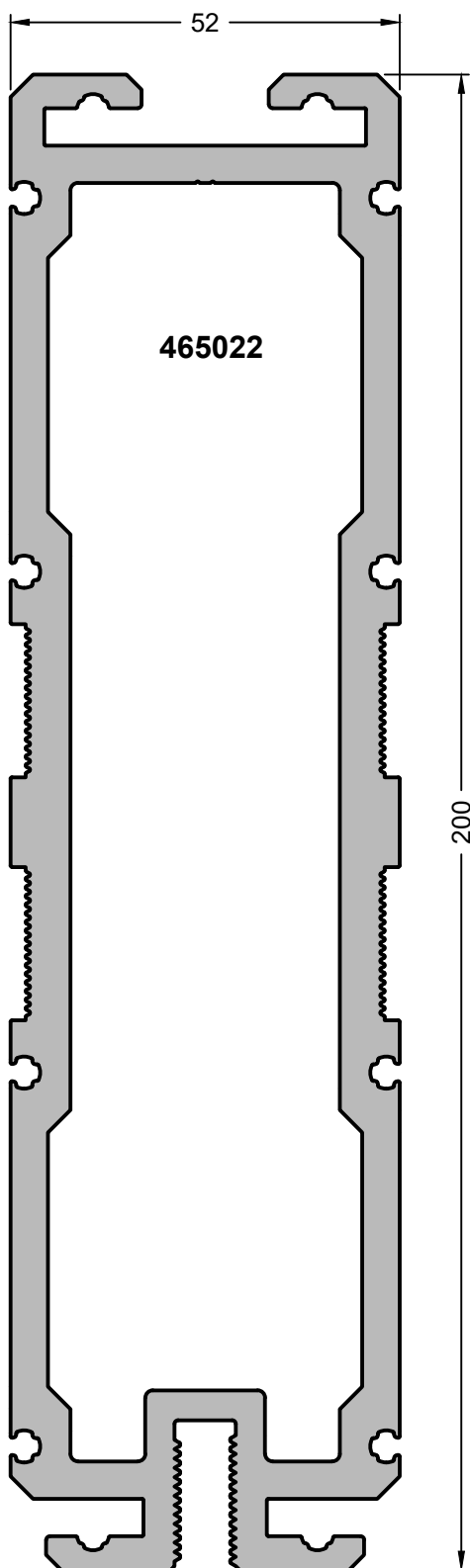

465022

Einschubprofil GCW 060 | Insert profile GCW 060



1



6000 mm

Auch zur Verwendung als Stoß- und Montagestoß-
verbinder.
Vor dem Zuschnitt von 465022 sind die Ist-Maße am
Pfostenprofil zu überprüfen.

Also usable as joint connector and as assembly joint
connector.
Please check mullion profile for actual dimensions
before cutting 465022.

Zuschnittsmaße in mm für Riegelprofil

Cutting dimensions in mm for transom profile

160055	160075	160095	160115	160135	160155	160175	160195	160215
40 $\begin{matrix} +0 \\ -0,5 \end{matrix}$	60 $\begin{matrix} +0 \\ -0,5 \end{matrix}$	80 $\begin{matrix} +0 \\ -0,5 \end{matrix}$	100 $\begin{matrix} +0 \\ -0,5 \end{matrix}$	120 $\begin{matrix} +0 \\ -0,5 \end{matrix}$	140 $\begin{matrix} +0 \\ -0,5 \end{matrix}$	160 $\begin{matrix} +0 \\ -0,5 \end{matrix}$	180 $\begin{matrix} +0 \\ -0,5 \end{matrix}$	200 $\begin{matrix} +0 \\ -0,5 \end{matrix}$

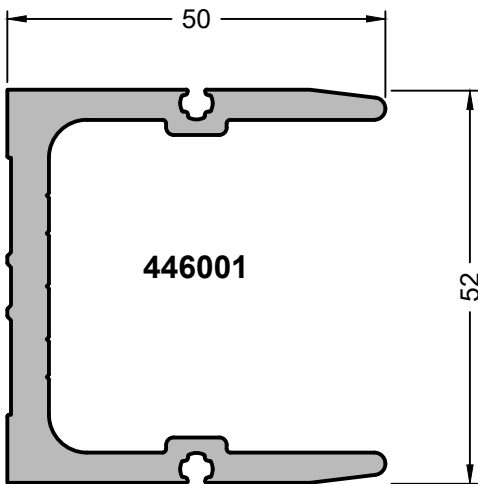

446001

Stoßverbinder GCW 060 | Joint connector GCW 060



1



6000 mm

Für Stoßverbinder in Eigenfertigung siehe
Anwendungs und Verarbeitungshinweis K-00473.

For in-house joint connectors, see application and
processing instructions K-00473.

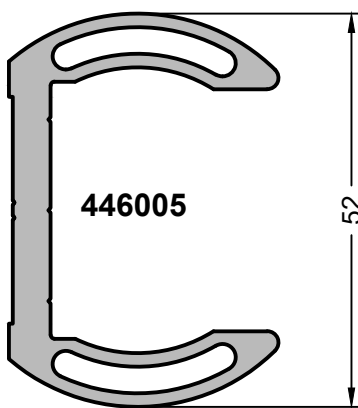

446005

Variabler Stoßverbinder | Variable joint connector



1



6000 mm

Für Stoßverbinder in Eigenfertigung siehe
Anwendungs und Verarbeitungshinweis K-00473.

For in-house joint connectors, see application and
processing instructions K-00473.

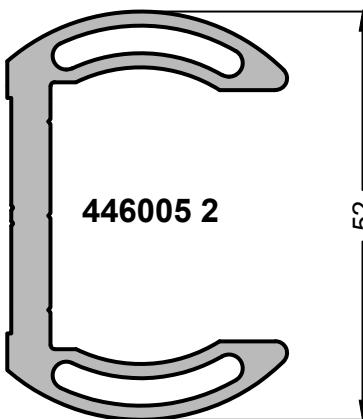

446005 2

Variabler Stoßverbinder | Variable joint connector



1



2000 mm

Für Stoßverbinder in Eigenfertigung siehe
Anwendungs und Verarbeitungshinweis K-00473.
Nur auf Anfrage!

For in-house joint connectors, see application and
processing instructions K-00473.
Upon request!

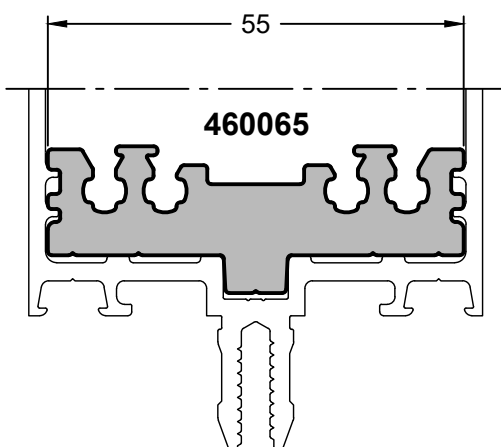

460065

Klemmplatte | Clamping plate



1



6000 mm



234 mm



-

