

## GUTMANN GCW 050

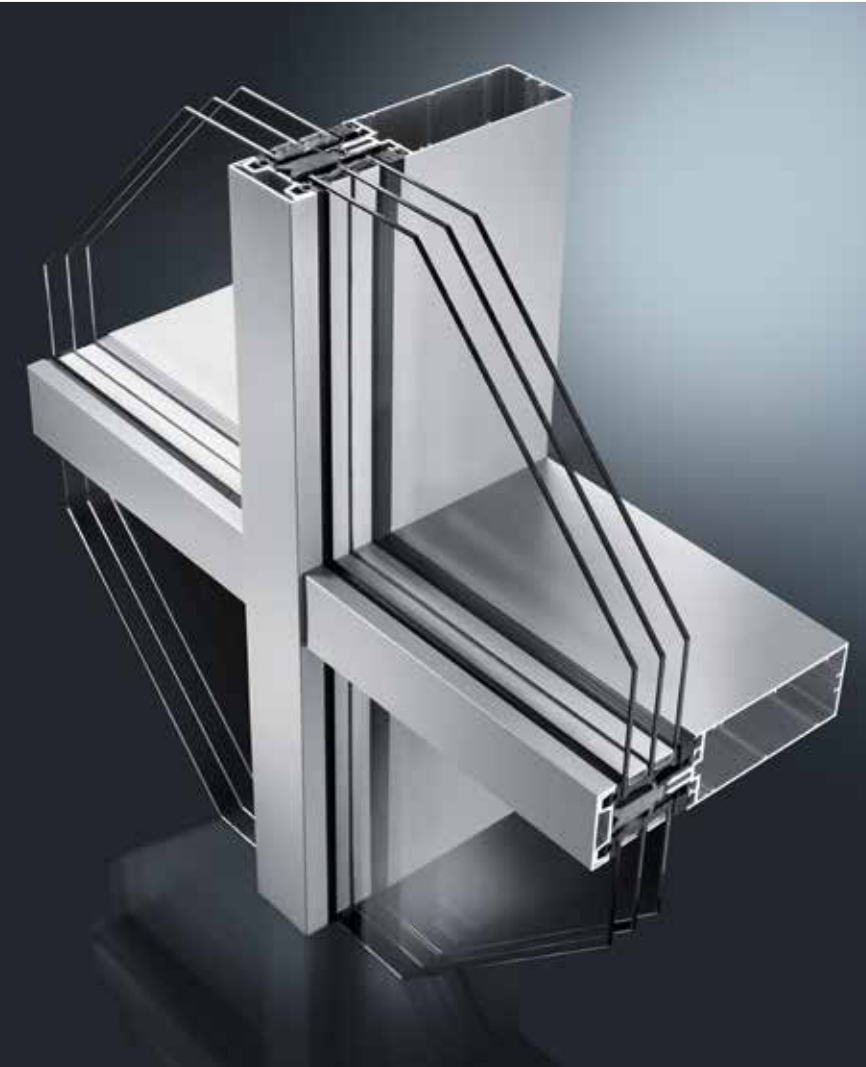
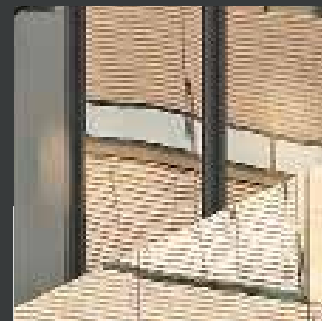

Blumenrain | Schweiz

ALUMINIUM  
FASSADEN-SYSTEM  
CURTAIN WALL SYSTEM

## SYSTEMBESCHREIBUNG

Das GUTMANN Fassadensystem GCW 050 bietet Raum für eine kreative Planung sowie eine solide Konstruktion. Der einheitliche Systemaufbau unterstützt eine wirtschaftliche und rationelle Fertigung. GUTMANN GCW 050 eignet sich gut für vertikale Fassaden. Alle Gebäudearten lassen sich leicht gestalten und verkleiden.

- › Füllstärken bis 65 mm.
- › Füllgewichte bis 550 kg
- › Uf - Werte bis 0,8 W/m<sup>2</sup>K
- › Identischer Isolator für Pfosten und Riegel
- › Gleiche Profile und Dichtungen für Pfosten und Riegel, gerade Zuschnitte, kein Ausklinken der Riegelprofile: Minimierter Verschnitt, rationelle Fertigung und Montage.
- › Hohe Wirtschaftlichkeit durch identische innere und äußere Verglasungsdichtung sowie der Möglichkeit der Verglasung mit Dichtungsrahmen (vulkanisiert).
- › Ausführung in Structural Glazing (SG), Semi SG, sowie als Passivhaus-System möglich.
- › Spezieller Riegelverbinder mit Kippmoment gegen Pfosten für spaltfreien Riegelanschluss.
- › Erhöhung der statischen Werte durch Einschieben von Alu- oder Stahlprofilen realisierbar.
- › Geringe Radien für einen optisch einwandfreien Riegelanschluss bei gleichen Profilen für Pfosten und Riegel

## SYSTEMEIGENSCHAFTEN / KLASSEN

	Schlagregendichtheit	<b>RE1200</b>		Windlast	<b>2,0 kN/m<sup>2</sup> 3,0 kN/m<sup>2</sup></b>
	Luftdurchlässigkeit	<b>AE</b>		Mechanische Festigkeit	<b>E5/I5</b>

## WÄRMEDÄMMUNG



<sup>1</sup> Elementgröße: 2.660 x 2665 mm | U<sub>g</sub> Wert: 0,7 W/m<sup>2</sup>K | U<sub>p</sub> Wert: 0,25 W/m<sup>2</sup>K |  
Glasabstandhalter: Thermix TX.N plus

## SYSTEMSCHNITTE

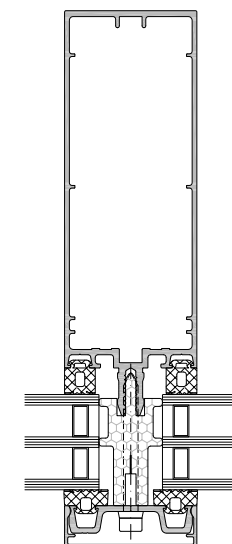
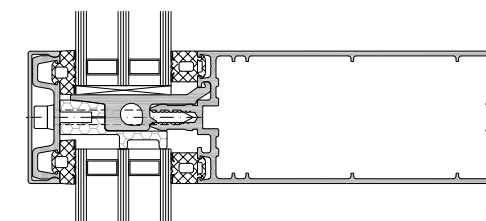



Symbolerklärung | Pictogram declaration

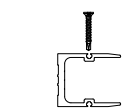

Schraube für Riegelbefestigung  
Screw for transom fastening

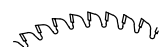

Zuschnittsmaß  
Cutting dimension



Verbinderprofil  
Connector profile

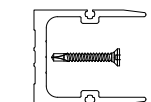

Schraube für Pfostenbefestigung  
Screw for mullion fastening

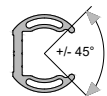

Stoßverbinder variabel  
Joint connector variable

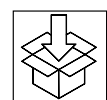

Verpackungseinheit  
Packaging unit

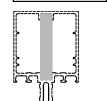

Einschiebling flach  
Insert flat

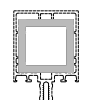

Einschiebling Rohr  
Insert tube

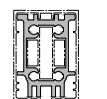

Einschubprofil  
Insert profile



Einschubprofil  
Insert profile

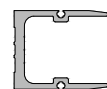

Stoßverbinder  
Joint connector

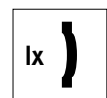

$I_x$  Trägheitsmoment  
 $I_x$  moment of inertia

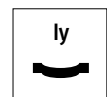

$I_y$  Trägheitsmoment  
 $I_y$  moment of inertia

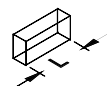

Lieferlänge  
Delivery length

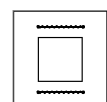

Abwicklung mechanisch  
execution mechanical

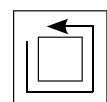

Abwicklung Eloxal  
execution anodic



Nur auf Anfrage!  
Upon request!



ohne AbZ!  
without general technical approval!

Serie   Series	Systemnummer   System number	Profilname	Profile name	Seite   Page
GCW 050	<a href="#">150030</a>	Pfosten/Riegel 30 mm	Mullion/transom 30 mm	3
GCW 050	<a href="#">150055</a>	Pfosten/Riegel 55 mm	Mullion/transom 55 mm	3
GCW 050	<a href="#">150075</a>	Pfosten/Riegel 75 mm	Mullion/transom 75 mm	4
GCW 050	<a href="#">150095</a>	Pfosten/Riegel 95 mm	Mullion/transom 95 mm	4
GCW 050	<a href="#">150115</a>	Pfosten/Riegel 115 mm	Mullion/transom 115 mm	5
GCW 050	<a href="#">150135</a>	Pfosten/Riegel 135 mm	Mullion/transom 135 mm	6
GCW 050	<a href="#">150155</a>	Pfosten/Riegel 155 mm	Mullion/transom 155 mm	7
GCW 050	<a href="#">150175</a>	Pfosten/Riegel 175 mm	Mullion/transom 175 mm	8
GCW 050	<a href="#">150195</a>	Pfosten/Riegel 195 mm	Mullion/transom 195 mm	9
GCW 050	<a href="#">151075</a>	Montagepfosten 75 mm	Assembly mullion 75 mm	10
GCW 050	<a href="#">151095</a>	Montagepfosten 95 mm	Assembly mullion 95 mm	10
GCW 050	<a href="#">151115</a>	Montagepfosten 115 mm	Assembly mullion 115 mm	11
GCW 050	<a href="#">151135</a>	Montagepfosten 135 mm	Assembly mullion 135 mm	12
GCW 050	<a href="#">151155</a>	Montagepfosten 155 mm	Assembly mullion 155 mm	13
GCW 050	<a href="#">152075</a>	Eckpfosten 75mm	Corner mullion 75 mm	14
GCW 050	<a href="#">159012</a>	Deckleiste	Cover plate	15
GCW 050	<a href="#">159016</a>	Deckleiste	Cover plate	15
GCW 050	<a href="#">159020</a>	Deckleiste	Cover plate	15
GCW 050	<a href="#">159025</a>	Deckleiste	Cover plate	15
GCW 050	<a href="#">159030</a>	Deckleiste	Cover plate	15
GCW 050	<a href="#">159031</a>	Deckleiste	Cover plate	15
GCW 050	<a href="#">159081</a>	Deckleiste	Cover plate	16
GCW 050	<a href="#">159100</a>	Deckleiste	Cover plate	16
GCW 050	<a href="#">159101</a>	Deckleiste	Cover plate	16
GCW 050	<a href="#">159210</a>	Druckleiste	Pressure strip	17
GCW 050	<a href="#">159225</a>	Druckleiste	Pressure plate	17
GCW 050	<a href="#">159230</a>	Druckleiste	Pressure plate	17
GCW 050	<a href="#">159301</a>	Druckleiste	Pressure strip	17
GCW 050	<a href="#">159303</a>	Druckleiste	Pressure plate	18
GCW 050	<a href="#">159305</a>	Druckleiste	Pressure plate	18
GCW 050	<a href="#">159307</a>	Druckleiste	Pressure plate	19
GCW 050	<a href="#">159308</a>	Druckleiste	Pressure plate	19
GCW 050	<a href="#">159309</a>	Druckleiste	Pressure strip	17
GCW 050	<a href="#">159310</a>	Druckleiste	Pressure strip	17
GCW 050	<a href="#">159310 L</a>	Druckleiste	Pressure plate	17
GCW 050	<a href="#">159310 U</a>	Druckleiste	Pressure plate	17
GCW 050	<a href="#">159311</a>	Druckleiste	Pressure strip	18
GCW 050	<a href="#">159312</a>	Druckleiste RC2	Pressure strip RC2	18
GCW 050	<a href="#">159313</a>	Druckleiste	Pressure strip	18
GCW 050	<a href="#">445001</a>	Stoßverbinderprofil	Joint connector profile	27
GCW 050	<a href="#">445005</a>	Variabler Stoßverbinder	Variable joint connector	27
GCW 050	<a href="#">445005 2</a>	Variabler Stoßverbinder	Variable joint connector	27
GCW 050	<a href="#">460064</a>	Klemmplatte	Clamping plate	27
GCW 050	<a href="#">465009</a>	Einschubprofil GCW 050	Insert profile GCW 050	20
GCW 050	<a href="#">465010</a>	Einschubprofil GCW 050	Insert profile GCW 050	20
GCW 050	<a href="#">465011</a>	Einschubprofil GCW 050	Insert profile GCW 050	26
GCW 050	<a href="#">465012</a>	Einschubprofil GCW 050	Insert profile GCW 050	21
GCW 050	<a href="#">465013</a>	Einschubprofil GCW 050	Insert profile GCW 050	22
GCW 050	<a href="#">465014</a>	Einschubprofil GCW 050	Insert profile GCW 050	23
GCW 050	<a href="#">465015</a>	Einschubprofil GCW 050	Insert profile GCW 050	24
GCW 050	<a href="#">465016</a>	Einschubprofil GCW 050	Insert profile GCW 050	25

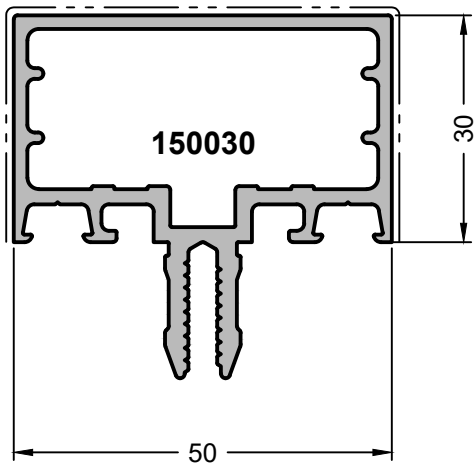

**150030**

**Pfosten/Riegel 30 mm | Mullion/transom 30 mm**

	1		6000 mm
	288 mm		110 mm
<b>I<sub>x</sub></b>	10,84 cm <sup>4</sup>	<b>I<sub>y</sub></b>	8,18 cm <sup>4</sup>

**Verbinder | Connectors**

	750601	445001	18 mm	834810	864219
		445005	18 mm	834810	864219 / 834213
		465011	20 mm	864219	

**Aussteifung | Stiffening**

		20x40x3		

Bei Einsatz der Einschieblinge (Rohr oder Flach)  
Statikliste K-00811 beachten!  
Nur auf Anfrage!

When using the inserts (pipe or flat), observe the  
static list K-00811!  
Upon request!

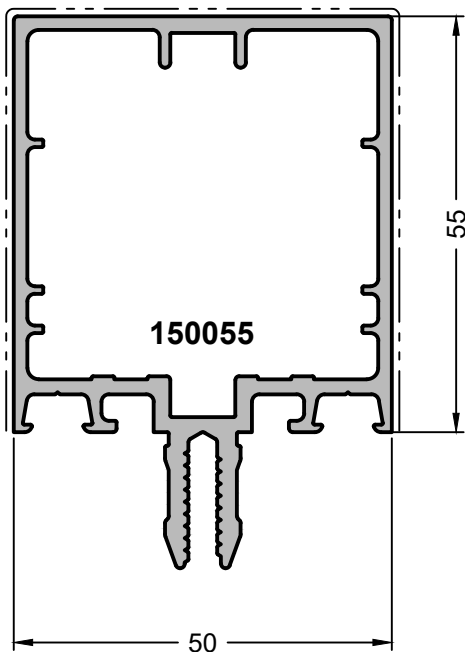

**150055**

**Pfosten/Riegel 55 mm | Mullion/transom 55 mm**

	1		6000 mm
	338 mm		160 mm
<b>I<sub>x</sub></b>	29,15 cm <sup>4</sup>	<b>I<sub>y</sub></b>	16,22 cm <sup>4</sup>

**Verbinder | Connectors**

	750602	445001	39 mm	834810	864219
		445005	39 mm	834810	864219 / 834213
		465011	40 mm	864219	

**Aussteifung | Stiffening**

		40x40x3		50x8



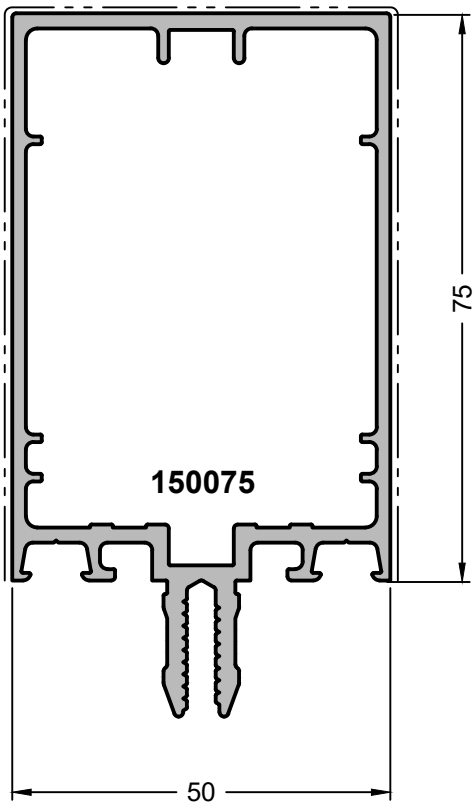

Bei Einsatz der Einschieblinge (Rohr oder Flach)  
Statikliste K-00811 beachten!

When using the inserts (pipe or flat), observe the  
static list K-00811!





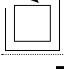
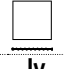

150075

Pfosten/Riegel 75 mm | Mullion/transom 75 mm

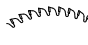
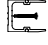
	1		6000 mm
	378 mm		200 mm
<b>I<sub>x</sub></b> 	58,91 cm <sup>4</sup>	<b>I<sub>y</sub></b> 	20,57 cm <sup>4</sup>

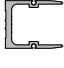
Verbinder | Connectors

					
	750603	445001	59 mm	834810	864219
		445005	59 mm	834810	864219 / 834213
		465011	60 mm	864219	

Aussteifung | Stiffening

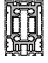
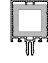
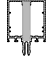
	465009		60x40x3		70x8
---	--------	---	---------	---	------





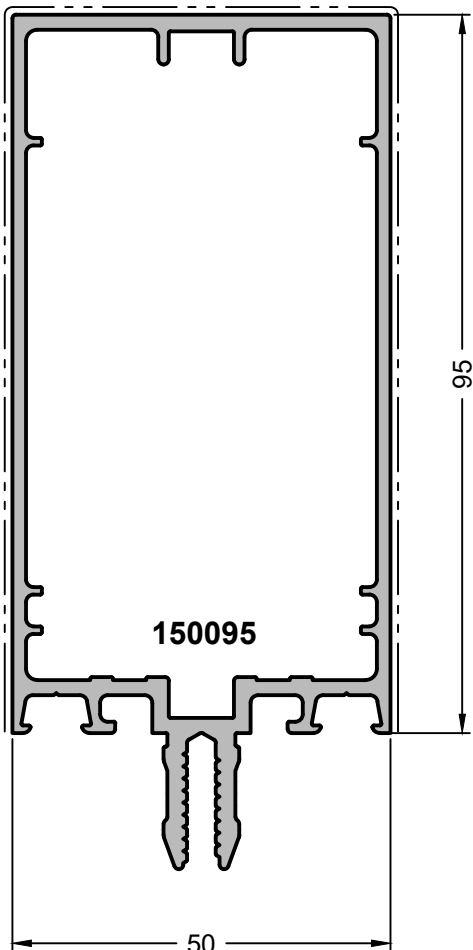

Bei Einsatz der Einschieblinge (Rohr oder Flach) Statikliste K-00811 beachten!

When using the inserts (pipe or flat), observe the static list K-00811!







150095

Pfosten/Riegel 95 mm | Mullion/transom 95 mm

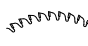
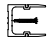
	1		6000 mm
	418 mm		240 mm
<b>I<sub>x</sub></b> 	100,46 cm <sup>4</sup>	<b>I<sub>y</sub></b> 	24,75 cm <sup>4</sup>

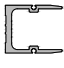
Verbinder | Connectors

					
	750604	445001	79 mm	834810	864219
		445005	79 mm	834810	864219 / 834213
		465011	80 mm	864219	

Aussteifung | Stiffening

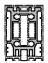
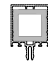
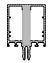
	465010		80x40x3		90x8
---	--------	---	---------	---	------

Bei Einsatz der Einschieblinge (Rohr oder Flach) Statikliste K-00811 beachten!

When using the inserts (pipe or flat), observe the static list K-00811!

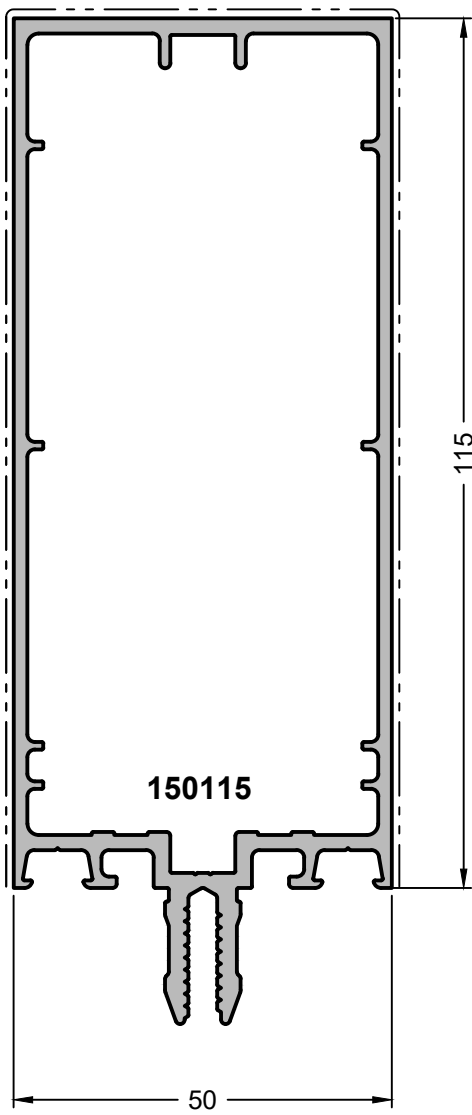

**150115**

**Pfosten/Riegel 115 mm | Mullion/transom 115 mm**

	1		6000 mm
	458 mm		280 mm
<b>I<sub>x</sub></b>	156,01 cm <sup>4</sup>	<b>I<sub>y</sub></b>	28,93 cm <sup>4</sup>

**Verbinder | Connectors**

	750605	445001	99 mm	834810	864219
		445005	99 mm	834810	864219 / 834213
		465011	100 mm	864219	

**Aussteifung | Stiffening**

	465012		100x40x3		110x8
--	--------	--	----------	--	-------



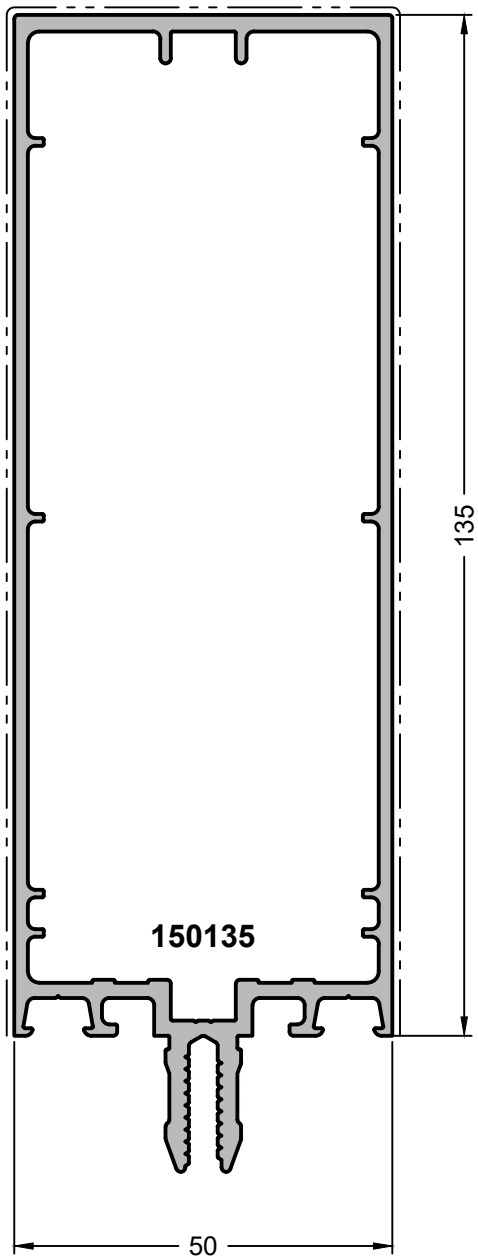

Bei Einsatz der Einschieblinge (Rohr oder Flach) Statikliste K-00811 beachten!

When using the inserts (pipe or flat), observe the static list K-00811!





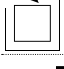
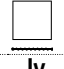

150135

Pfosten/Riegel 135 mm | Mullion/transom 135 mm

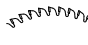
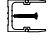
	1		6000 mm
	498 mm		320 mm
<b>I<sub>x</sub></b> 	230,80 cm <sup>4</sup>	<b>I<sub>y</sub></b> 	32,91 cm <sup>4</sup>

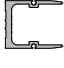
Verbinder | Connectors

					
	750606	445001	119 mm	834810	864219
		445005	119 mm	834810	864219 / 834213
		465011	120 mm	864219	

Aussteifung | Stiffening

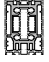
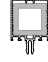
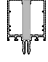
	465013		120x40x3		130x8
---	--------	---	----------	---	-------

Bei Einsatz der Einschleiblinge (Rohr oder Flach)  
Statikliste K-00811 beachten!

When using the inserts (pipe or flat), observe the  
static list K-00811!

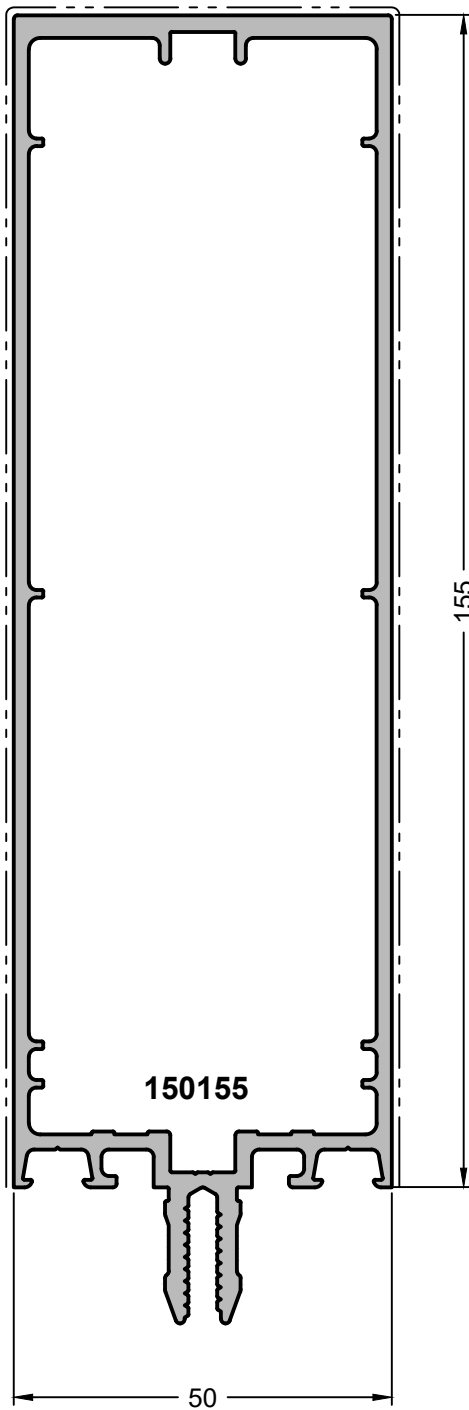

**150155**

**Pfosten/Riegel 155 mm | Mullion/transom 155 mm**

	1		6000 mm
	538 mm		360 mm
<b>I<sub>x</sub></b>	350,60 cm <sup>4</sup>	<b>I<sub>y</sub></b>	41,15 cm <sup>4</sup>

**Verbinder | Connectors**

	750607	445001	139 mm	834810	864219
		445005	139 mm	834810	864219 / 834213
		465011	140 mm	864219	

**Aussteifung | Stiffening**

	465014		140x40x3		150x8
--	--------	--	----------	--	-------



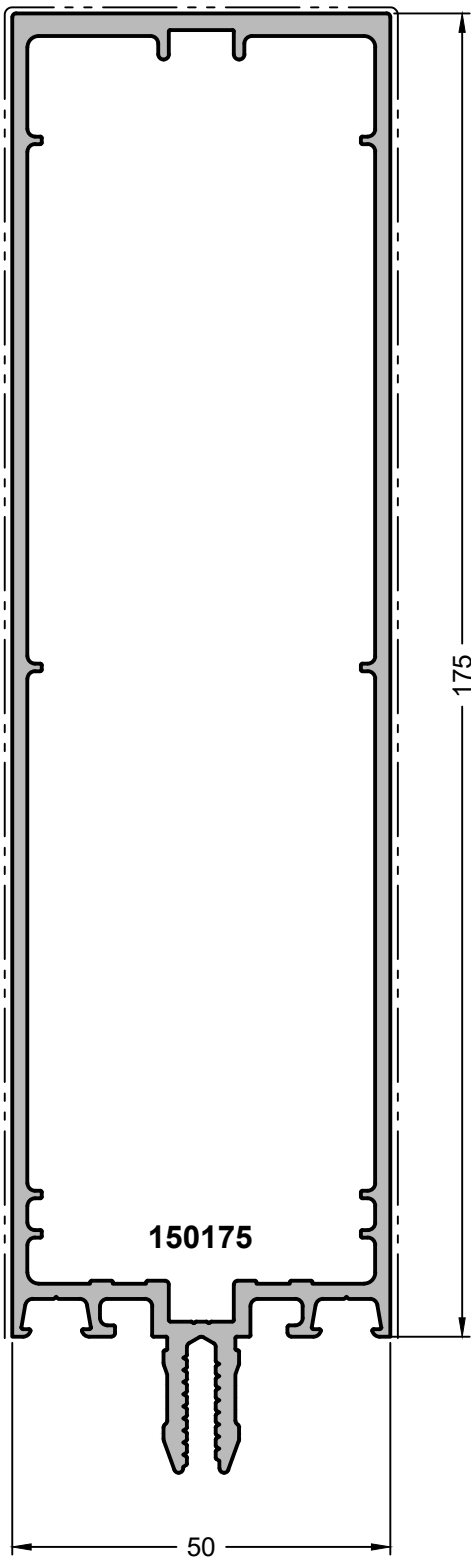

Bei Einsatz der Einschieblinge (Rohr oder Flach)  
Statikliste K-00811 beachten!

When using the inserts (pipe or flat), observe the  
static list K-00811!





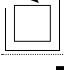
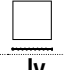

150175

Pfosten/Riegel 175 mm | Mullion/transom 175 mm

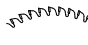
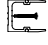
	1		6000 mm
	576 mm		400 mm
<b>I<sub>x</sub></b> 	467,64 cm <sup>4</sup>	<b>I<sub>y</sub></b> 	45,76 cm <sup>4</sup>

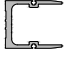
Verbinder | Connectors

					
	750608	445001	159 mm	834810	864219
		445005	159 mm	834810	864219 / 834213
		465011	160 mm	864219	

Aussteifung | Stiffening

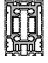
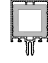
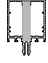
	465015		160x40x3		170x8
---	--------	---	----------	---	-------

Bei Einsatz der Einschleiblinge (Rohr oder Flach)  
Statikliste K-00811 beachten!

When using the inserts (pipe or flat), observe the  
static list K-00811!



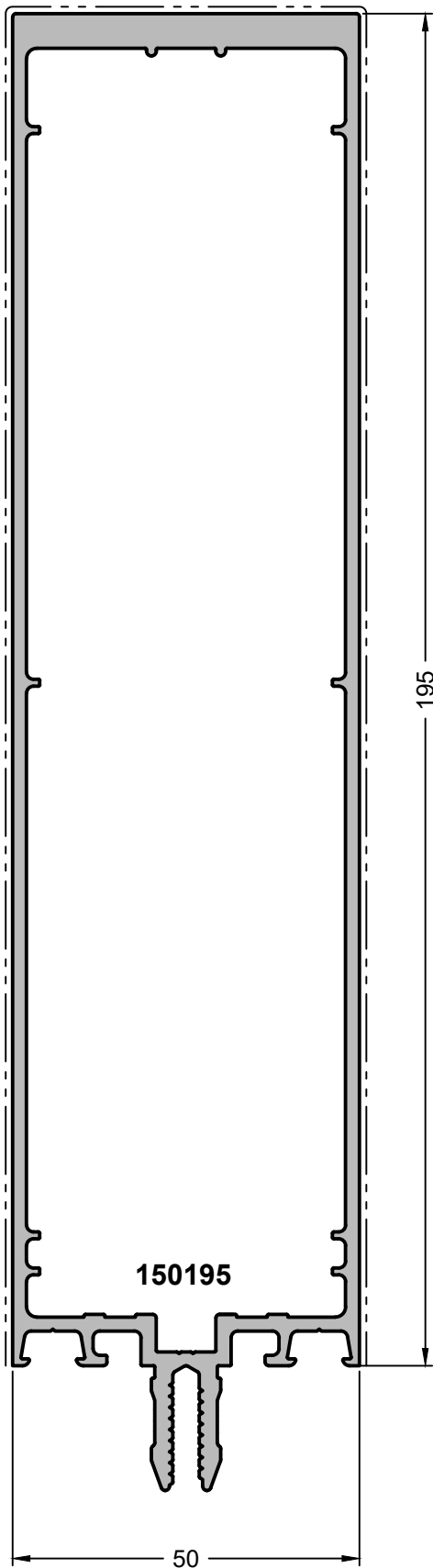

**150195**

**Pfosten/Riegel 195 mm | Mullion/transom 195 mm**

	1		6000 mm
	618 mm		440 mm
<b>I<sub>x</sub></b>	695,53 cm <sup>4</sup>	<b>I<sub>y</sub></b>	52,13 cm <sup>4</sup>

**Verbinder | Connectors**

	750609	445001	179 mm	834810	864219
		445005	179 mm	834810	864219 / 834213
		465011	180 mm	864219	

**Aussteifung | Stiffening**

	465016		180x40x3		
--	--------	--	----------	--	--

Bei Einsatz der Einschieblinge (Rohr oder Flach) Statikliste K-00811 beachten!





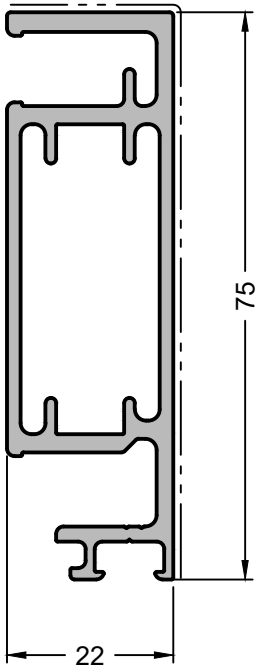

When using the inserts (pipe or flat), observe the static list K-00811!

**151075**

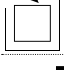

**151075**

**Montagepfosten 75 mm | Assembly mullion 75 mm**

	1		6000 mm
	282 mm		97 mm
<b>I<sub>x</sub></b> 	24,88 cm <sup>4</sup>	<b>I<sub>y</sub></b> 	2,81 cm <sup>4</sup>

**Aussteifung | Stiffening**

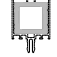
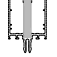
	30x15x2		40x8
---	---------	---	------

Bei Einsatz der Einschieblinge (Rohr oder Flach)  
Statikliste K-00811 beachten!



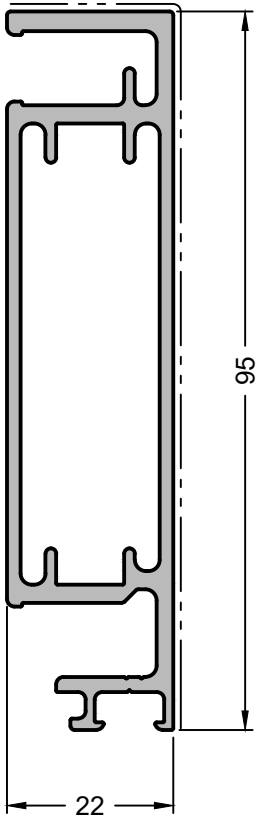

When using the inserts (pipe or flat), observe the  
static list K-00811!

**151095**

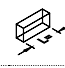
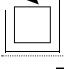

**151095**

**Montagepfosten 95 mm | Assembly mullion 95 mm**

	1		6000 mm
	322 mm		117 mm
<b>I<sub>x</sub></b> 	48,46 cm <sup>4</sup>	<b>I<sub>y</sub></b> 	3,56 cm <sup>4</sup>

**Aussteifung | Stiffening**

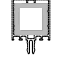
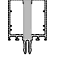
	50x15x2		60x8
---	---------	---	------

Bei Einsatz der Einschieblinge (Rohr oder Flach)  
Statikliste K-00811 beachten!

When using the inserts (pipe or flat), observe the  
static list K-00811!

**151115**

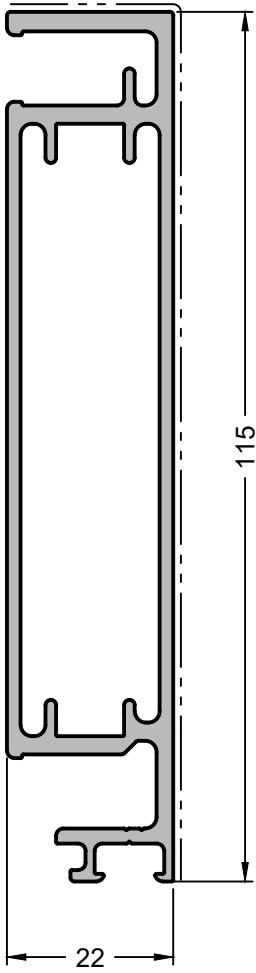

**151115**

**Montagepfosten 115 mm | Assembly mullion 115 mm**

	1		6000 mm
	362 mm		137 mm
<b>I<sub>x</sub></b>	82,44 cm <sup>4</sup>	<b>I<sub>y</sub></b>	4,31 cm <sup>4</sup>

**Aussteifung | Stiffening**

	70x15x2		80x8
--	---------	--	------

Bei Einsatz der Einschieblinge (Rohr oder Flach)  
Statikliste K-00811 beachten!



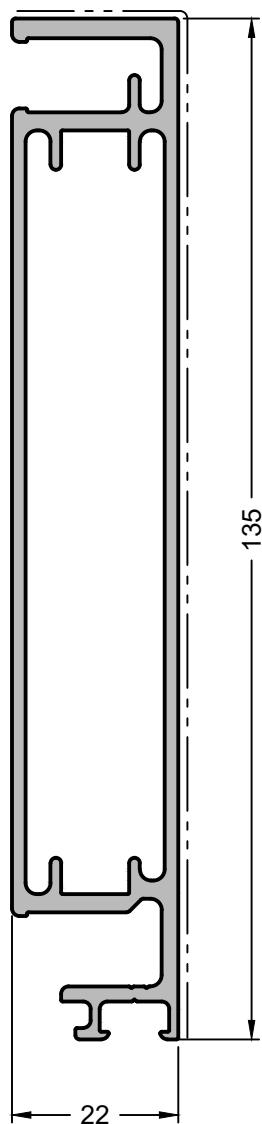

When using the inserts (pipe or flat), observe the  
static list K-00811!

**151135**

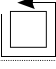
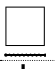

**151135**

**Montagepfosten 135 mm | Assembly mullion 135 mm**

	1		6000 mm
	402 mm		157 mm
<b>Ix</b> 	128,18 cm <sup>4</sup>	<b>Iy</b> 	5,04 cm <sup>4</sup>

**Aussteifung | Stiffening**

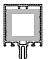
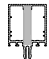
	90x15x2		100x8
---	---------	---	-------

Bei Einsatz der Einschieblinge (Rohr oder Flach)  
Statikliste K-00811 beachten!



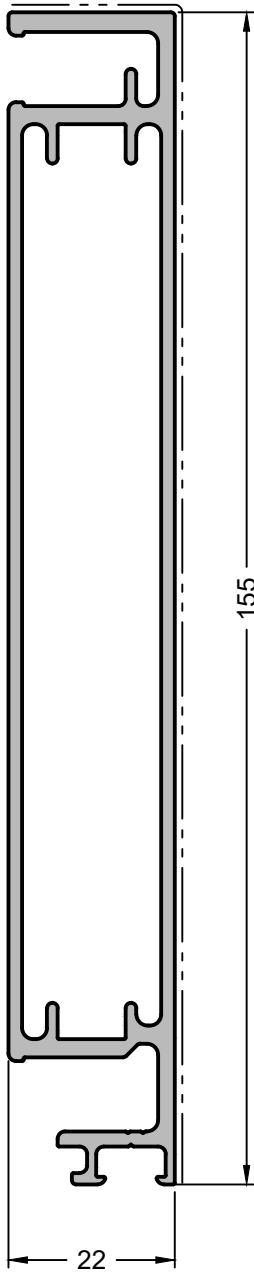

When using the inserts (pipe or flat), observe the  
static list K-00811!

**151155**

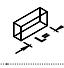
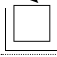

**151155**

**Montagepfosten 155 mm | Assembly mullion 155 mm**

	1		6000 mm
	442 mm		177 mm
<b>ix</b> 	187,13 cm <sup>4</sup>	<b>ly</b> 	5,80 cm <sup>4</sup>

**Aussteifung | Stiffening**

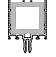
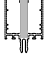
	110x15x2		120x8
---	----------	---	-------



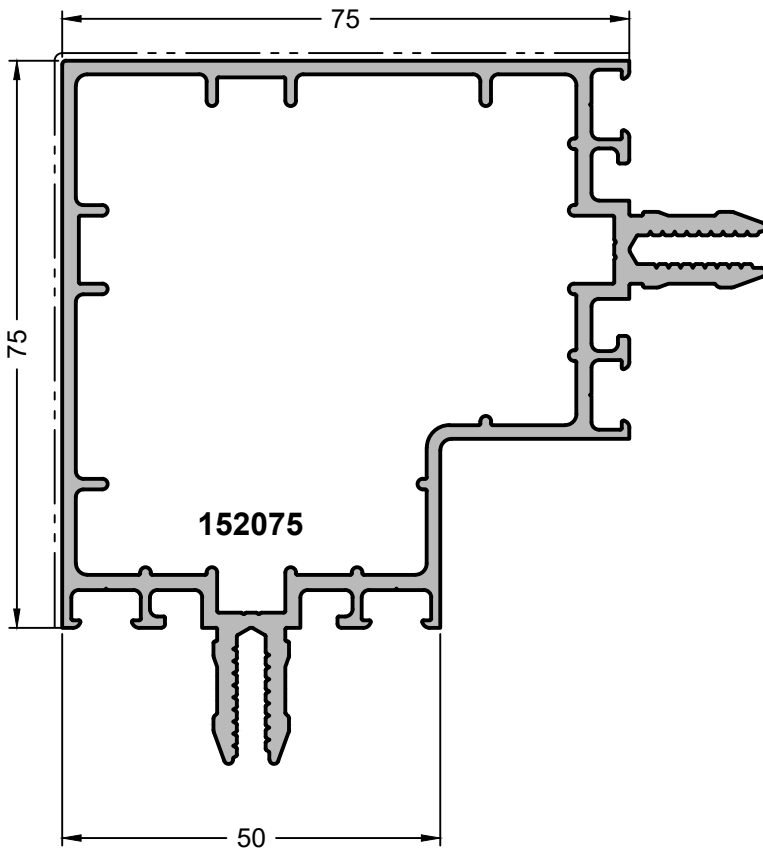

Bei Einsatz der Einschieblinge (Rohr oder Flach)  
Statikliste K-00811 beachten!

When using the inserts (pipe or flat), observe the  
static list K-00811!

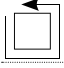

152075

Eckpfosten 75mm | Corner mullion 75 mm

	1		6000 mm
	556 mm		200 mm
<b>I<sub>x</sub></b> )	70,69 cm <sup>4</sup>	<b>I<sub>y</sub></b> )	70,69 cm <sup>4</sup>

Aussteifung | Stiffening

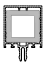
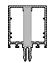
	60x40x3		70x8
---	---------	---	------

Bei Einsatz der Einschieblinge (Rohr oder Flach)  
Statikliste K-00811 beachten!

When using the inserts (pipe or flat), observe the  
static list K-00811!

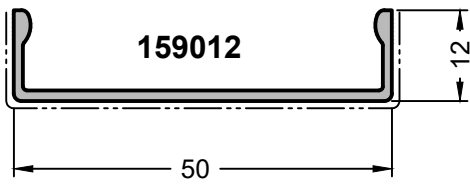

**159012**

**Deckleiste | Cover plate**

	1		6000 mm
	145 mm		74 mm

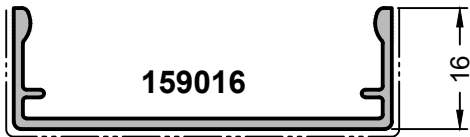

**159016**

**Deckleiste | Cover plate**

	1		6000 mm
	170 mm		82 mm

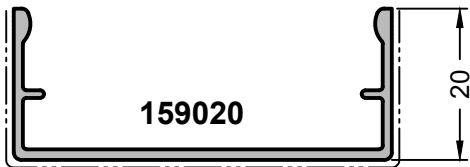

**159020**

**Deckleiste | Cover plate**

	1		6000 mm
	186 mm		90 mm

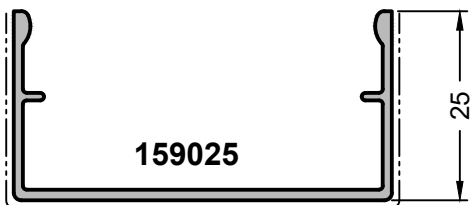

**159025**

**Deckleiste | Cover plate**

	1		6000 mm
	206 mm		100 mm

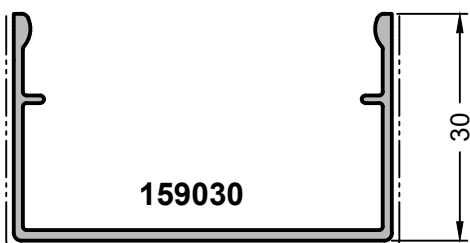

**159030**

**Deckleiste | Cover plate**

	1		6000 mm
	226 mm		110 mm

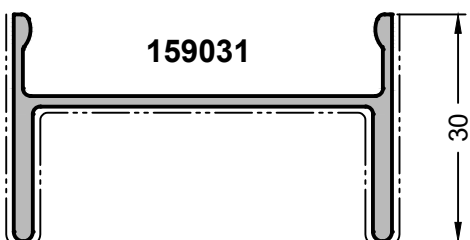

**159031**



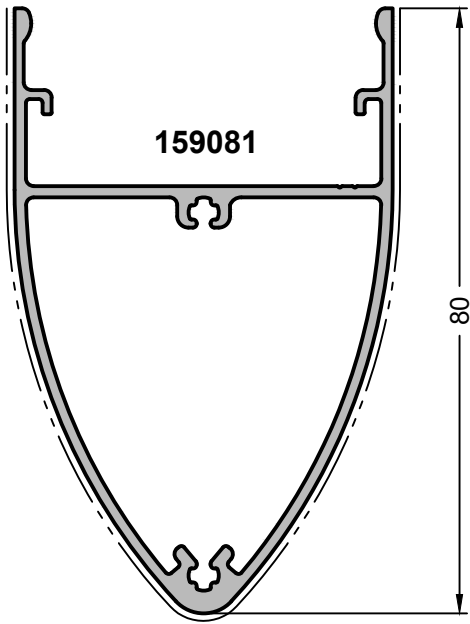

**Deckleiste | Cover plate**

	1		6000 mm
	214 mm		146 mm



**159081**

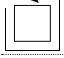

**Deckleiste | Cover plate**

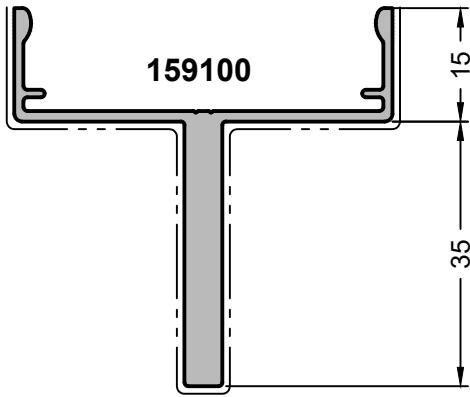
	1		6000 mm
	292 mm		175 mm



**159100**

**Deckleiste | Cover plate**

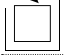
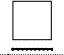
	1		6000 mm
	236 mm		150 mm

Nur auf Anfrage!

Upon request!

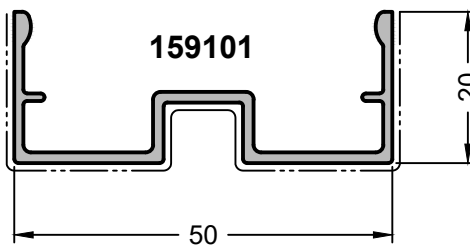

**159101**

**Deckleiste | Cover plate**

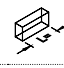
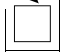
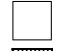
	1		6000 mm
	216 mm		106 mm

Nur auf Anfrage!

Upon request!



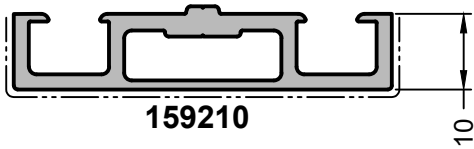

**159210**

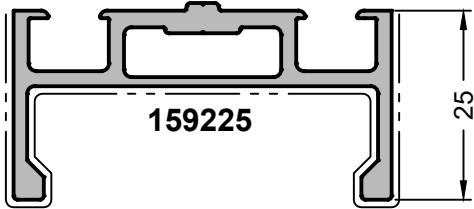

**159225**

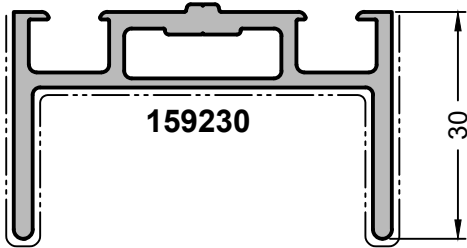

**159230**

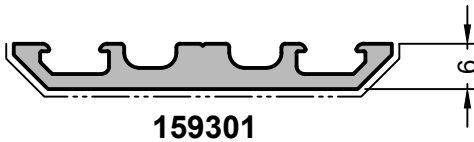

**159301**

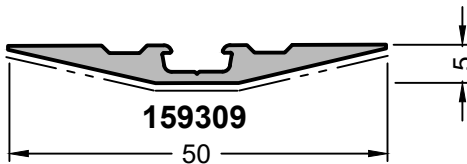

**159309**

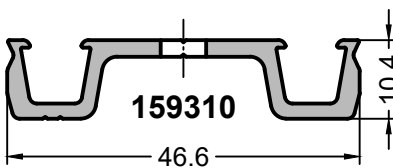

**159310**

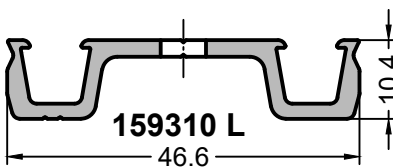

**159310 L**

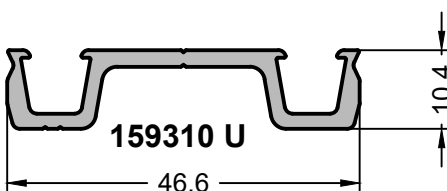

**159310 U**

**159210**

**Druckleiste | Pressure strip**

	1		6000 mm
	162 mm		71 mm

**159225**

**Druckleiste | Pressure plate**

	1		6000 mm
	228 mm		136 mm

**159230**

**Druckleiste | Pressure plate**

	1		6000 mm
	241 mm		148 mm

**159301**

**Druckleiste | Pressure strip**

	1		6000 mm
	136 mm		57 mm

**159309**

**Druckleiste | Pressure strip**

	1		6000 mm
	112 mm		52 mm

**159310**

**Druckleiste | Pressure strip**

	1		6000 mm
<b>Gelocht Ø 6 mm</b>		<b>Punched Ø 6 mm</b>	



**159310 L**

**Druckleiste | Pressure plate**

	1		6000 mm
<b>Langloch 7 x 20 mm. Nur auf Anfrage!</b>		<b>Oblong hole 7 x 20 mm. Upon request!</b>	



**159310 U**

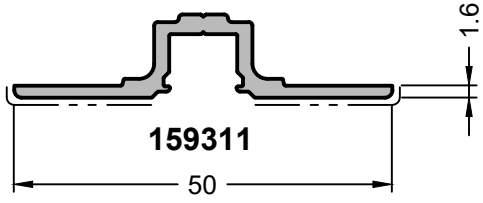

**Druckleiste | Pressure plate**

	1		6000 mm
<b>Ohne Bearbeitung. Nur auf Anfrage!</b>		<b>Without processing. Upon request!</b>	



159311

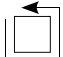
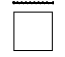

Druckleiste | Pressure strip

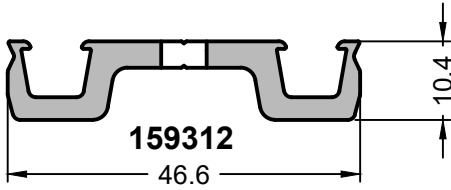
	1		6000 mm
	135 mm		38 mm



159312

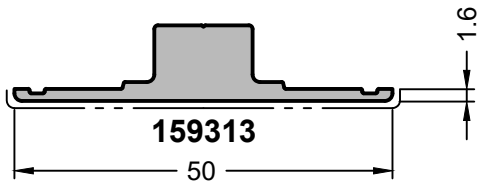

Druckleiste RC2 | Pressure strip RC2

	1		6000 mm
Druckleiste für RC2 Einsatz. Gelocht Ø 6 mm.		Pressure strip for RC2 use. Punched Ø 6 mm.	



159313

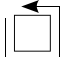
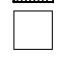

Druckleiste | Pressure strip

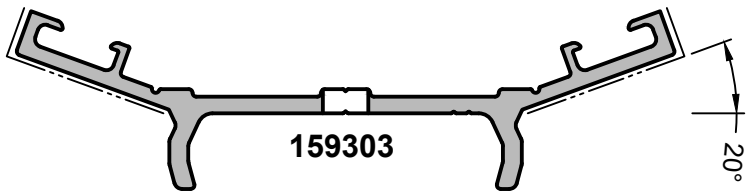
	1		6000 mm
	119 mm		50 mm



159303



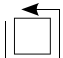
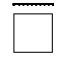

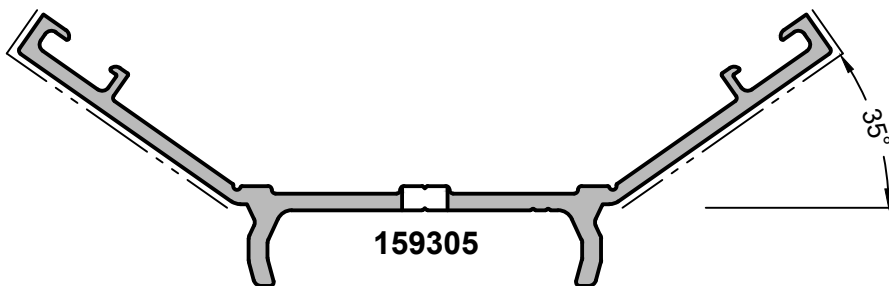
Druckleiste | Pressure plate

	1		6000 mm
	266 mm		53 mm
Gelocht Ø 6 mm.		Punched Ø 6 mm	

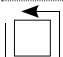

159305

Druckleiste | Pressure plate

	1		6000 mm
	327 mm		80 mm
Gelocht Ø 6 mm		Punched Ø 6 mm	

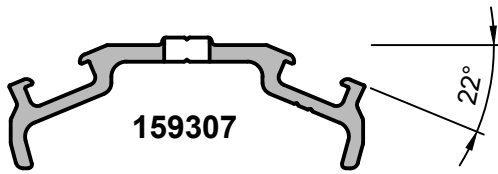

159307

Druckleiste | Pressure plate



1



6000 mm

Gelocht Ø 6 mm

Punched Ø 6 mm

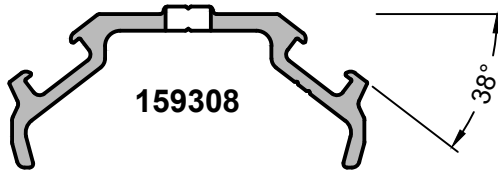

159308

Druckleiste | Pressure plate



1



6000 mm

Gelocht Ø 6 mm

Punched Ø 6 mm

**465009**

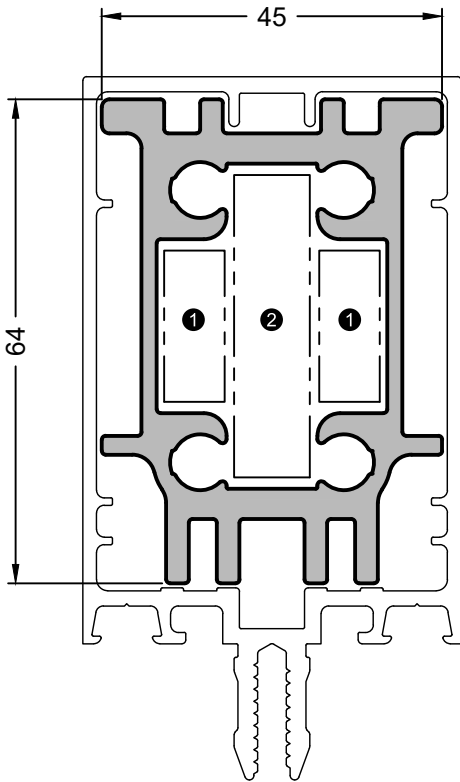

**465009**

**Einschubprofil | Insert profile**



1



6000 mm

**I<sub>x</sub>**

37,97 cm<sup>4</sup>

**I<sub>y</sub>**

13,77 cm<sup>4</sup>

Passend zu 150075

Suitable for 150075



①

8 x 20 mm

②

10 x 40 mm

**465010**

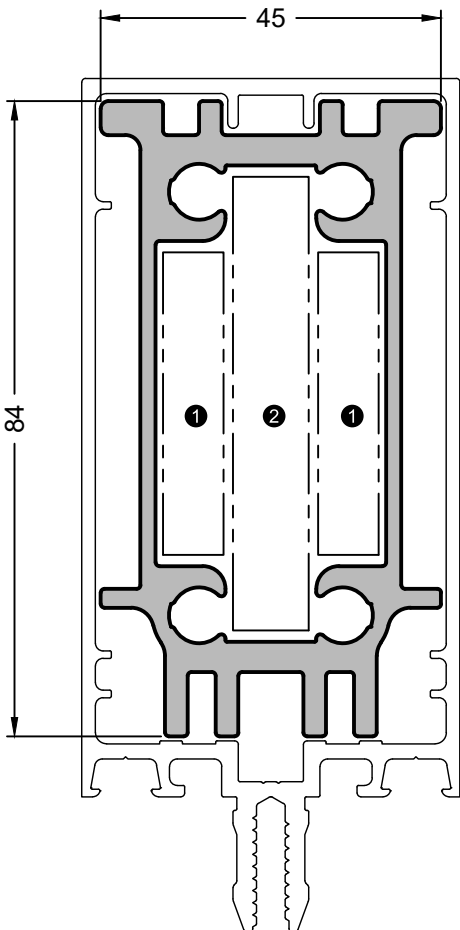

**465010**

**Einschubprofil | Insert profile**



1



6000 mm

**I<sub>x</sub>**

79,54 cm<sup>4</sup>

**I<sub>y</sub>**

15,89 cm<sup>4</sup>

Passend zu 150095

Suitable for 150095



①

8 x 40 mm

②

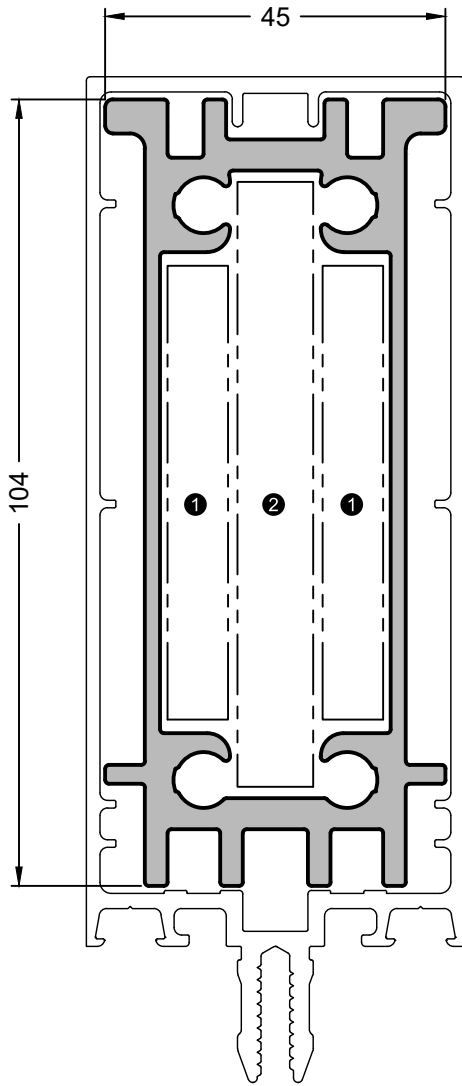

10 x 60 mm

**465012**



**465012**

**Einschubprofil | Insert profile**

	1		6000 mm
<b>I<sub>x</sub></b>	141,87 cm <sup>4</sup>	<b>I<sub>y</sub></b>	19,04 cm <sup>4</sup>
Passend zu 150115		Suitable for 150115	
	<b>1</b>	8 x 60 mm	
	<b>2</b>	10 x 80 mm	

### 465013

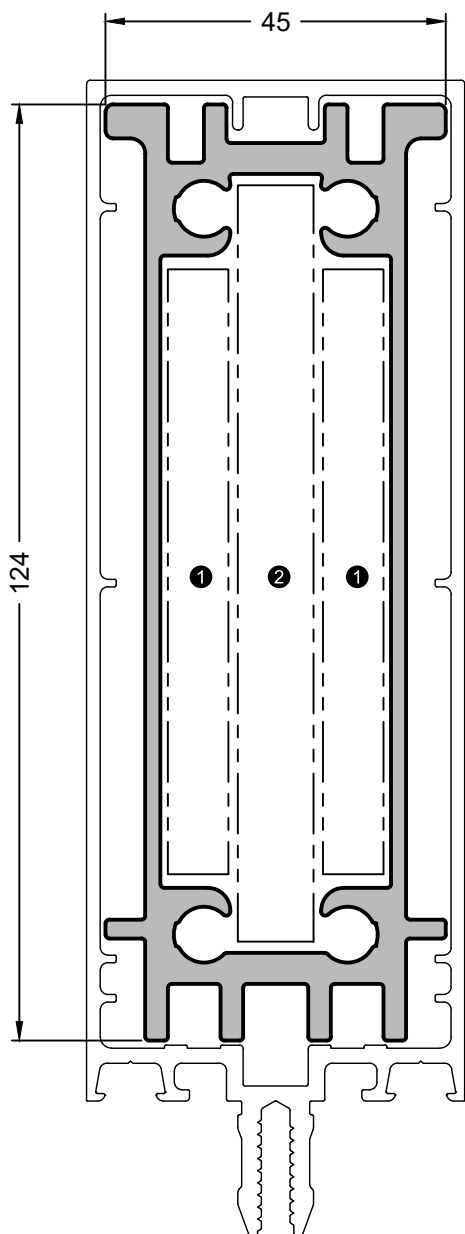

### 465013

#### Einschubprofil | Insert profile



1



6000 mm

$I_x$

220,82cm<sup>4</sup>

$I_y$

21,09 cm<sup>4</sup>

Passend zu 150135

Suitable for 150135



①

8 x 80 mm

②

10 x 100 mm

**465014**



465014

Einschubprofil | Insert profile



1



6000 mm



312,68 cm<sup>4</sup>



22,04 cm<sup>4</sup>

Passend zu 150155

Suitable for 150155



①

8 x 100 mm

②

10 x 120 mm

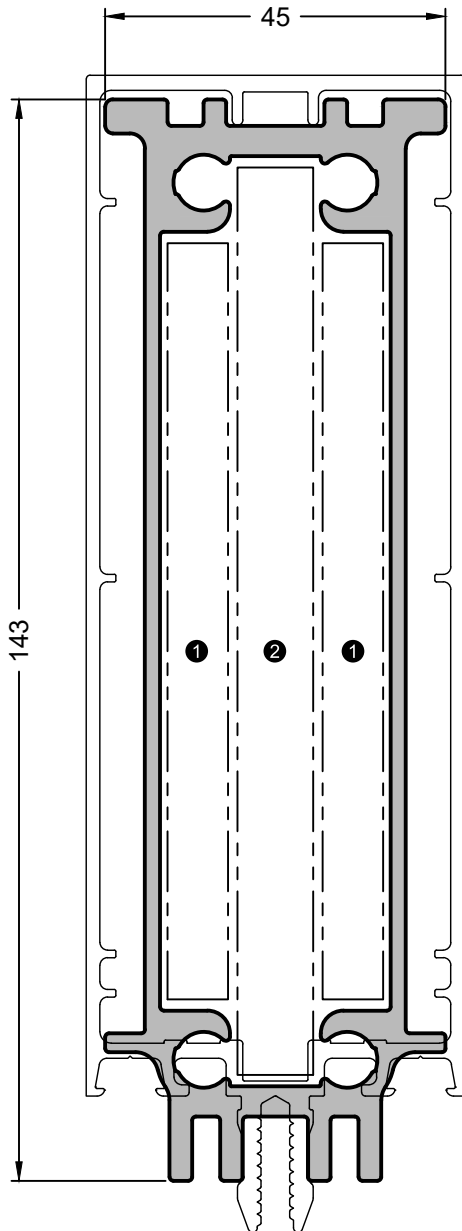

**465015**



**465015**

**Einschubprofil | Insert profile**



1



6000 mm

**I<sub>x</sub>**

434,25 cm<sup>4</sup>

**I<sub>y</sub>**

24,16 cm<sup>4</sup>

Passend zu 150175

Suitable for 150175



①

8 x 120 mm

②

10 x 140 mm

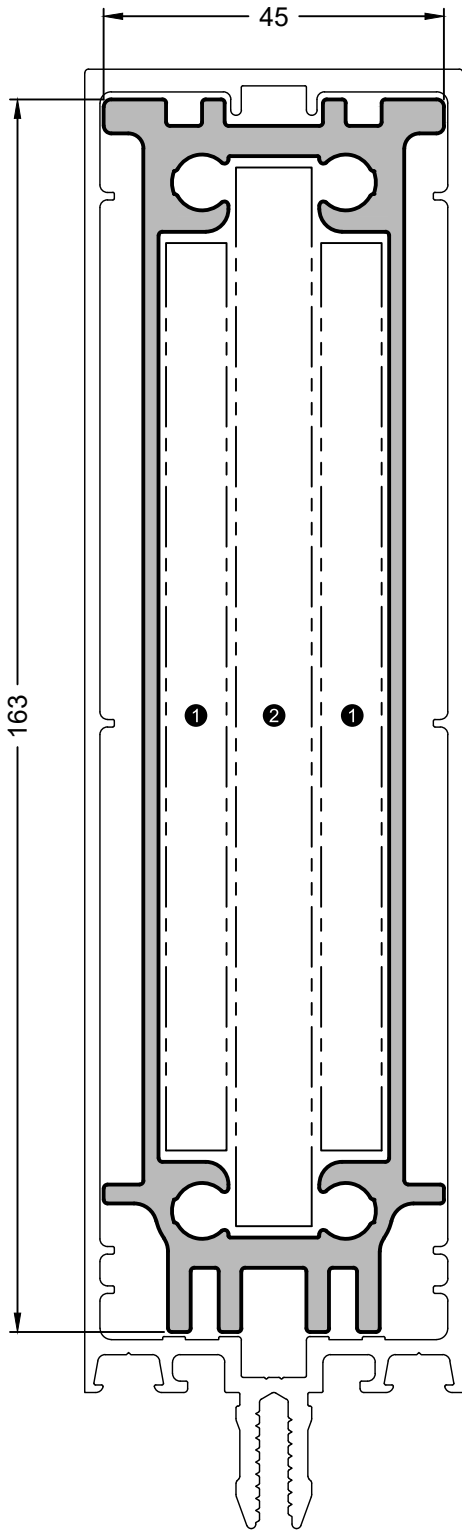

163

45

①

②

①



**465016**



465016

Einschubprofil | Insert profile



1



6000 mm

**I<sub>x</sub>**

547,90 cm<sup>4</sup>

**I<sub>y</sub>**

25,27 cm<sup>4</sup>

Passend zu 150195

Suitable for 150195



①

8 x 140 mm

②

10 x 160 mm

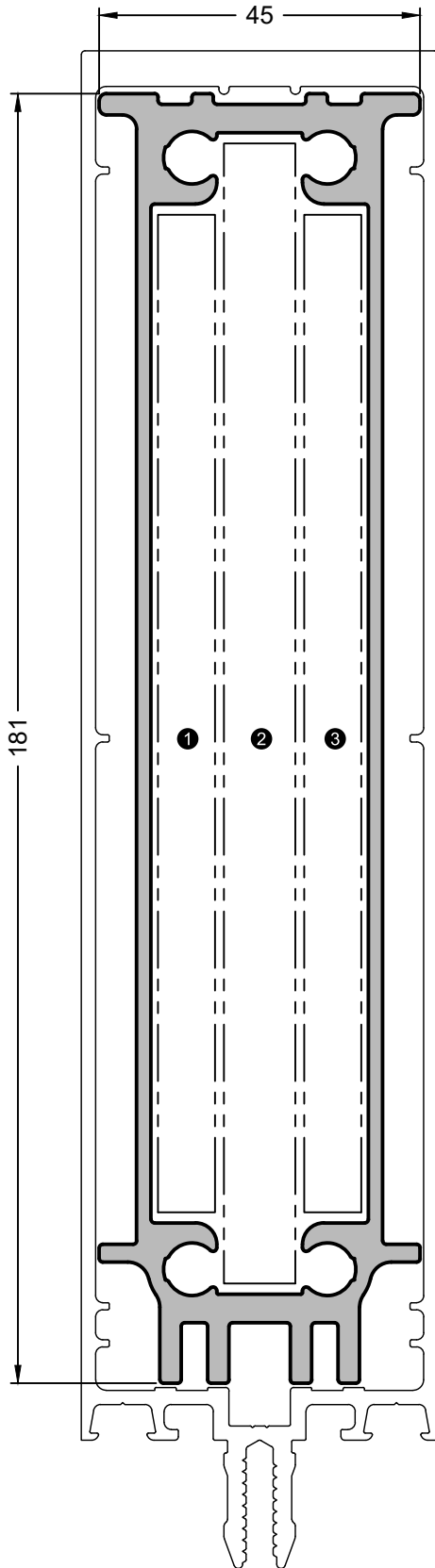

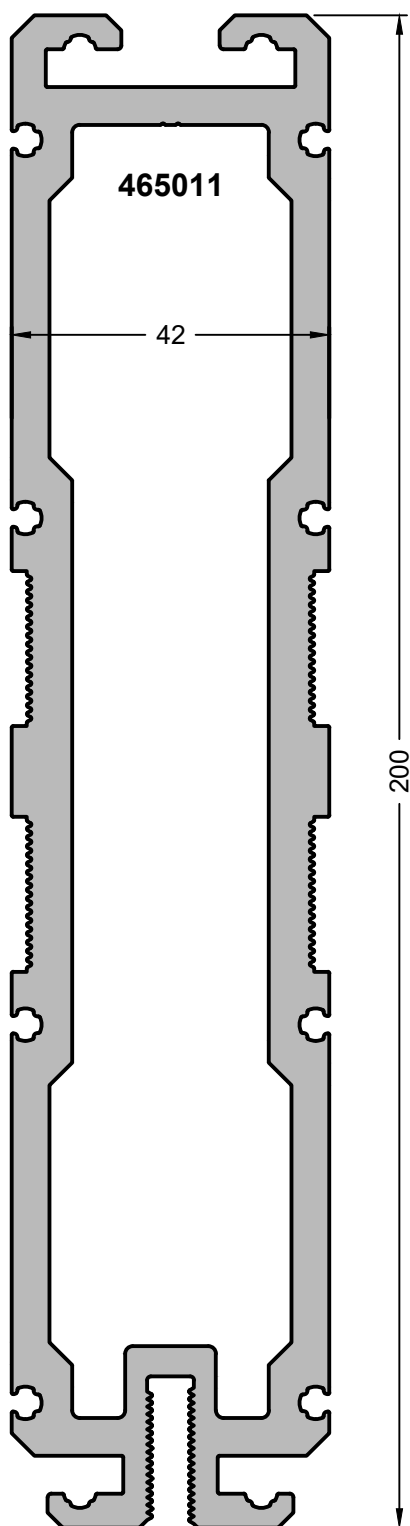

465011

Einschubprofil GCW 050 | Insert profile GCW 050



1



6000 mm

Auch zur Verwendung als Stoß- und Montagestoß-  
verbinder.

Also usable as joint connector and assembly joint  
connector.

Zuschnittsmaße in mm für Riegelprofil

Cutting dimensions in mm for transom profile

150030	159055	150075	150095	150115	150135	150155	150175	150195
20 $\begin{matrix} +0 \\ -0,5 \end{matrix}$	40 $\begin{matrix} +0 \\ -0,5 \end{matrix}$	60 $\begin{matrix} +0 \\ -0,5 \end{matrix}$	80 $\begin{matrix} +0 \\ -0,5 \end{matrix}$	100 $\begin{matrix} +0 \\ -0,5 \end{matrix}$	120 $\begin{matrix} +0 \\ -0,5 \end{matrix}$	140 $\begin{matrix} +0 \\ -0,5 \end{matrix}$	160 $\begin{matrix} +0 \\ -0,5 \end{matrix}$	180 $\begin{matrix} +0 \\ -0,5 \end{matrix}$

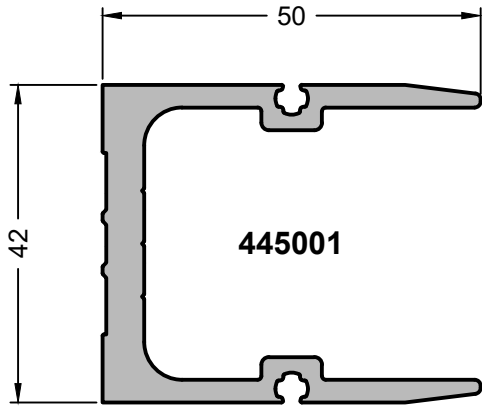

445001

Stoßverbinderprofil | Joint connector profile



1



6000 mm

Für Stoßverbinder in Eigenfertigung siehe  
Anwendungs und Verarbeitungshinweis K-00373.

For in-house joint connectors, see application and  
processing instructions K-00373.

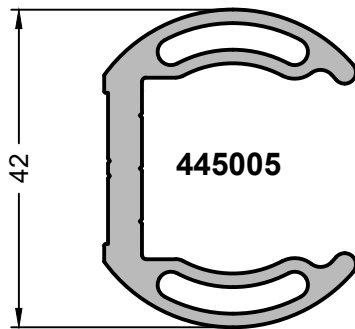

445005

Variabler Stoßverbinder | Variable joint connector



1



6000 mm

Für Stoßverbinder in Eigenfertigung siehe  
Anwendungs und Verarbeitungshinweis K-00373.

For in-house joint connectors, see application and  
processing instructions K-00373.

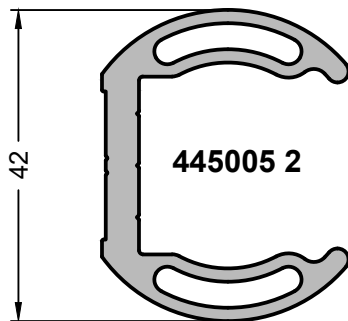

445005 2

Variabler Stoßverbinder | Variable joint connector



1



2000 mm

Für Stoßverbinder in Eigenfertigung siehe  
Anwendungs und Verarbeitungshinweis K-00373.  
Nur auf Anfrage!

For in-house joint connectors, see application and  
processing instructions K-00475.  
Upon request!

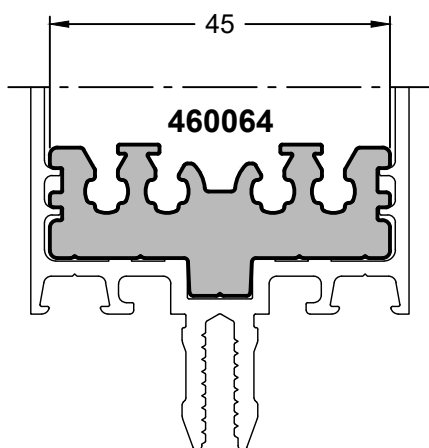

460064

Klemmplatte | Clamping plate



1



6000 mm



219 mm



-

